

Architecture from future \ Waiting future you

LUBAN.CABIN



Architecture from future.Waiting future you

Core values,Grow because of sharing,Simpleness because of trust ,Achievement because of gratitude,Do it best or not do it,
Fight hard and never give up,Live seriously and work happily

CONTENTS

BRAND INTRODUCTION

CHAPTER 1

Brand culture	01
Brand slogan	03
Brand advantage	05

Company introduction

CHAPTER 2

Company profile	07
Organizational structure	09
Team leader	09
Founder talks	11
Enterprise team	13
Development course	15
Factory image	17
Qualification certificate	21

PRODUCT INTRODUCTION

CHAPTER 3

Production advantage	23
Product Standards	24
Structural analysis	25
AI intelligent system	27
Product catalog	31
Product display	35
Internal configuration	67

ONE-STOP SERVICE

CHAPTER 4

Application scenario	69
Camp planning	71
Landing case	73
Transportation mode	77

GLORY MOMENT

CHAPTER 5

Signing ceremony	81
Beautiful moment	83
Cooperation brand	85



LUBAN -- FROM THE PERSPECTIVE OF LUBAN SPIRIT

Lu Ban (507-444 BC) was an excellent inventor in ancient China. All his life, Luban paid attention to practice, was good at using his brain, and made great contributions in construction and machinery. He was able to build "palace terrace", made "ladder" for siege, "Gouqiang" for boat warfare: created a wooden horse car, invented a ruler, ink fountain, plane, chisel and other wood tools, but also invented the mill, roller, lock and so on. In order to encourage construction enterprises to strengthen management and promote the general improvement of engineering quality in China, the "China Construction Engineering Luban Award" was set up by the China Construction Industry Federation in 1987.

Why are we called "Luban Cabin"? We should inherit the spirit of Lu Ban , that is, the spirit of benefiting people, pioneering and innovating, and pursuing perfection and Ultimate perfection. We regard Lu Ban as our teacher and confidant; With our dialogue with our ancestors, we understand this spirit, so as to apply it to our product manufacturing and research and development, the management of the team and the responsibility for the development of the motherland. We are not just producing a commodity, we are undertaking a mission. A united China to share, strong exploration, never give up the power through the luban building luban cabin brand read to the world. Let luban cabin not only has commercial value, but also has cultural value. With the spirit of Lu Ban to build things conducive to human development, for the benefit of people all over the world. Learn from the past and serve the present; use luban craftsmanship, create benefit human luban cabin.

"Promoting the transformation of 'Made in China' to 'Created in China,'
the shift from 'Chinese speed' to 'Chinese quality,'
and the transition from 'Chinese products' to 'Chinese brands'."

--General Secretary Xi Jinping, attending the deliberation of the Jiangsu delegation
at the First Session of the Fourteenth National People's Congress.

BRAND CULTURE - FROM THE PERSPECTIVE OF TRADITIONAL CULTURE

President Xi said that traditional Chinese culture is the foundation of the nation's well-being, and that the road to socialism with Chinese characteristics is, in the final analysis, about firming up cultural self-confidence, which is a more fundamental, deeper, and more enduring force.

luban cabin Firmly follow the footsteps of President Xi, to learn from the past and use the past for the present; with the work of Luban, to build things that benefit the people. Nourish the enterprise with excellent traditional culture and confident enterprise. In ancient times, Luban's great creation changed people's life; nowadays, Luban's scientific research and innovation help the development of Chinese nation. As a Chinese enterprise rooted in scientific and technological creation and research and aiming at benefiting the people and the country, we are shouldering a great and honorable mission. We will add bricks and mortar to the goal proposed by Comrade Xi Jinping, which is "to promote the transformation of Made-in-China to Created-in-China, the

02 | CULTURAL
SLOGAN
LUBANICABIN

ARCHITECTURE FROM FUTURE,
WAITING FUTURE YOU.

The beauty of the future architecture can only be understood by trying.
There is always a star for you.

LUBAN CABIN - WITH THE SPIRIT OF LUBAN, WE BUILD THINGS THAT BENEFIT THE PEOPLE

Throughout the 5,000 years of China's glorious road, countless outstanding representative people or events have pushed the gears of change again and again. Each change has brought about a substantial leap forward in people's lives.

The gears of history have been turning so far, and the responsibility of the new era should be undertaken by us in the new era. In the ancient times, Lu Ban's great creation changed people's life; today, Luban Cabin's scientific research and innovation help the development of Chinese nation. Nowadays, the scientific research and innovation of Luban Cabin helps the development of Chinese nation. Luban Cabin, as a Chinese enterprise rooted in scientific and technological creation and research and aiming at benefiting the people and the country, are shouldering a great and honorable mission.

Why our brand is "Luban Cabin"! Firstly, it is because our company was founded in Qilu, where Luban was born, and his life full of creation has established his extraordinary status and influence in the world history. Secondly, it is because we want to inherit the spirit of Luban, i.e. the spirit of benefiting people and helping the world, pioneering and innovating, and pursuing perfection and extremity. We regard Luban as our teacher, confidant, and talk with our ancestor, and we understand this spirit and apply it to the manufacturing and research and development of our products, the management of our team, and the development of our motherland. We are not only producing a commodity, but also undertaking a mission. We are also adding bricks and mortar to the goal proposed by Comrade Xi Jinping, "Promoting the transformation of Made-in-China to Created-in-China, the transformation of China's speed to China's quality, and the transformation of China's products to China's brands". We are going to read out the spirit of Chinese unity and sharing, strong exploration and never give up to the world through the brand of "Luban Cabin". Let the brand of "Luban Cabin" have not only commercial value, but also cultural value. With the spirit of Luban's innovation, refinement and pursuit of perfection, we will build products that are beneficial to the development of mankind and benefit people all over the world.

As heirs of the times, we should, with sincerity, express our awe and respect for the ancient Chinese craftsmen represented by Lu Ban. Respect their efforts to promote the development of the times and the sacrifices they made to improve the quality of life of the people. Let us inherit this spirit, so that we can better answer the new propositions given by the new era.



- ① The brand logo also echoes the theme of extracting torch and human modeling elements, focusing on embodying the spirit of passing on the flame.
- ② The Chinese logo adopts regular square characters, straight and smooth strokes, and square edges and corners. Architectural aesthetics are integrated into the font design, highlighting the feeling of architectural rigidity and highlighting the brand tonality accumulated by LUBAN CABIN.
- ③ In the English design, more emphasis on reflecting the sense of science and technology and the sense of the future, the turning point is smooth, the font outline is concise and continuous, which is convenient for subsequent application while giving the product a sense of science and technology.
- ④ This logo is composed of brand symbol graphics, Chinese and English, which is easier to identify and promote. It fully embodies the craftsmanship spirit of LUBAN CABIN about building products and continuous improvement.

<p>ONE-STOP FULL-LINK CUSTOMIZED PRODUCTION (UNIQUE)</p>	<p>INDEPENDENT DESIGN AND DEVELOPMENT TEAM</p>
<p>Aluminum veneer independent production</p>	<p>Support OEM</p>
<p>Fluorocarbon baking paint</p>	<p>130+ patents</p>
<p>Decoration team</p>	<p>Customized whole case service</p>
<p>MODULAR PRODUCTION</p>	<p>NATIONAL AFTERSALES GUARANTEE</p>
<p>Split transport, save logistics costs</p>	<p>Regional fixed point service</p>

FAMOUS BRAND INTERNATIONAL STYLE

We have invested heavily in market construction at home and abroad, actively participated in various industry exhibitions and exchange activities, and strengthened publicity and promotion. We have achieved good market reputation and brand influence.

GROUP COMPANY HIGH DELIVERABILITY

We have modern production processes and equipment, as well as an experienced manufacturing team to ensure production efficiency and quality. We have modern production processes and equipment, as well as an experienced manufacturing team, which can guarantee production efficiency and quality, and ensure that customer orders are delivered on time and perfectly presented.

PATTERN SHARING AGENTS EASILY

We provide our partners with an agency model of co-operation, so that partners can easily sell our products, and give after-sales service and after-sales service support. We always uphold the concept of close to the customer, to help partners in business development more efficient and worry-free.

MODULE PRODUCTION AND DISASSEMBLY WITHOUT WORRY

Flexible customisation and high productivity, we use on-demand custom design, through in-depth understanding of customer needs, tailor-made product style, to provide customers with personalised and high-quality custom services. We use the on-demand design method, through in-depth understanding of customer needs, tailored to the style of the product, to provide customers with personalised and high-quality custom services.

04 | COMPANY PROFILE

LUBAN·CABIN



LUBAN CABIN is a member of the Hong Kong Huati Group, which was first established in 2003, and has a cultural tourism segment (Shandong Infinity Landscape Engineering Co. Ltd.), building materials, cold chain, and commercial mixing, etc. In 2022, the sales of the whole group will be more than 2 billion, and the sales of the cultural tourism sector will be about 600 million, and the B&B capsule will account for about 1.5 billion. In 2022, the sales of the whole group will be more than 2 billion dollars, and the sales of cultural tourism segment will be about 600 million dollars, and the B&B space capsule will account for about 500 million dollars.

LUBAN CABIN is an intelligent assembled building brand innovated by Shandong Infinity Landscape Engineering Co., Ltd. The company was registered and established in 2013, and was rated as a national high-tech enterprise. The company focuses on the design, research and development of scenic area ancillary equipment; large-scale steel structure amusement equipment; airplanes, high-speed railways, trains and other large-scale featured lodging; high-end hotels, scenic campsites and other operational solutions. The company focuses on the design, research and development and production of scenic area supporting equipment; large-scale steel structure amuse-

ment equipment; airplanes, high-speed trains and other large-scale characteristic lodgings; high-end hotels, scenic area camps and other operational solutions. The total area of our factory is about 200,000 square meters (300 acres), and the monthly delivery can reach more than 200 sets. We have rich experience in production and sales in the industry, and our products are exported to all over the world.

LUBAN CABIN brand is committed to building intelligent assembly building brand, research and development of various terrain-limited mobile homes. The products mainly meet the needs of cultural and tourism real estate, core scenic spots, commercial supporting facilities, RV camps and other aspects. Since the product development and design success in 2018, we have continuously launched the Starship. Since the success of product development and design in 2018, a series of products such as starships, nebulae, and star charts have been launched, providing personalized customized solutions for more than 50 campgrounds and scenic spots at home and abroad. It has provided personalized customized solutions for more than 50 camp scenic spots at home and abroad, including 100 sets for Beijing International Hotel, 100 sets for Wuhan Guangshui Moonlight Island and 200 sets for Henan Yuntai Mountain. The products have been exported to South Korea, Canada, New Zealand, Australia and other countries, and have gained good international reputation.

Our company was awarded the first European Union quality inspection report (also the only one to be certified) and is also the first company in China to pass the quality inspection report issued by the government. We are also the first enterprise in China to pass the quality inspection report issued by the government, and have won many certifications (ISO9001 quality system, international SGS, TUV field inspection, product structural safety testing, product CE, etc.). factory, product structural safety testing, product CE, etc.), with product invention patents, utility model patents, appearance patents and so on. More than 130 items.

With the work of Luban to build things that benefit the people, the Group is committed to conveying the innovative and creative spirit of Chinese artisans contained in Luban, the originator of Chinese architecture, to every corner of the world, so that the world can witness the unique Chinese made (intelligent) made and created in China!

LUBAN·CABIN

05

ORGANIZATIONAL STRUCTURE

LUBAN·CABIN

Team leader



Liam Xiang

LUBAN CABIN BRAND FOUNDER

Liam Xiang is a visionary and innovative young post-80s entrepreneur who believes that technology and innovation are important driving forces for social progress and enterprise development. His extensive engineering background and technical prowess, as well as his keen insight into market trends and user needs, have made him a pioneer in the space capsule field.

Liam Xiang co-founded Shandong Endless Landscape Engineering Co., LTD with He Qianqian in 2013, which is a new model of steel structure housing in China. He found that the traditional brick-concrete structure of the house is difficult to meet the needs of modern life and environmental protection requirements, but the steel structure of the market has poor decorative effect, difficult construction, high price and other problems. So he began to think about how to make steel buildings better.

As one of the founders of the startup company, Liam Xiang is mainly responsible for the production and design of products, he has invested a lot of energy in product design and process manufacturing, and created a new set of mobile homestay solution - Luban Future Cabin, to achieve rapid production on a scale, while taking into account the decorative effect and environmental protection requirements. This innovation has led the trend of the industry, and Luban Future Cabin has gradually been recognized and promoted in the Chinese market, becoming another commercial success for him.

As a successful entrepreneur, he paid attention to the construction of production design team, attracted a group of excellent engineers to join the team, and led the team to constantly explore and innovate, which promoted the rapid development of the company's production. Through his own entrepreneurial process and successful experience, Liam Xiang has constantly encouraged and promoted young people's innovation and entrepreneurship, and made due contributions to the development of Chinese enterprises.



Serena He

LUBAN CABIN BRAND FOUNDER

Serena He is a post-80s female entrepreneur with a keen business sense and innovative thinking. During the company's growth, she researched the global market in depth and saw great potential in the emerging market of family-style lodging. She realized that people's needs for accommodation when they travel are not only practical and comfortable, but also a desire for unique experiences and a family atmosphere.

As one of the founders of the startup company, Serena He is mainly responsible for brand operation and promotion, domestic and foreign market development and sales, need to face a lot of difficulties and challenges. She needs to constantly find new market opportunities, develop new products, recruit talent and raise capital etc. In the process of entrepreneurship, she understood that the difficulties and challenges she encountered were just a normal condition on the way forward. She overcame everything with firm faith and continuous efforts. As a leader, she could always lead the team to grow all the time.

After founding Shandong Endless Landscape Engineering Co., LTD., Serena He was not satisfied with creating a mobile cabin brand. She saw a broader opportunity for development. So in 2016, she and Liam Xiang co-founded the mobile homestay brand "Luban Future Cabin" and launched a series of personalized mobile homestay products.

After years of development, its products cover many countries and regions around the world. Today, Luban Future Cabin has become one of the leading enterprises in China's mobile homestay industry.



EXCHANGE AND STUDY WITH MR. CAO DEWANG

Serena He, the founder of Luban brand, sought a more suitable development path for the mobile cabin and asked Mr. Cao for advice and learning.

This exchange study has a profound discussion on how to expand the economic market of mobile cabins and how to plan the enterprise road. At present, mobile cabins meet the needs of people's tourism consumption, and diversified and interesting accommodation experience breaks the limitations brought by traditional accommodation methods. With the continuous expansion of domestic tourism market, The application scenarios of mobile homestay have also become more diverse. Whether it is mountains, beaches or cities, you can see the figure of mobile homestay. This also provides more opportunities for the development of mobile homestay.

After several years of large-scale expansion, the global express hotel has felt the threat of the space capsule hotel: in just 5 years, it has developed to all over the world, and in the next 10 years, it will quickly sweep the entire hotel industry, which will reallocate the entire domestic hotel industry.

In the past, hotel chains represented a fashion trend that was popular with business people. According to statistics, since 2016, no less than 8 million graduates a year to find jobs in the city, these graduates with relatively low economic ability have brought huge business opportunities for space capsule hotels.

In addition, with the huge extension of domestic high-speed rail and the expansion of airports, high-quality and convenient space capsule hotels began to enter these places with rich passenger sources. Hospitals, childcare center, e-sports Internet cafes and other special space capsule hotels will also bloom everywhere. The market potential is huge.

As the leader of the enterprise, she also seize the opportunity, seize the market, lead the direction of the enterprise, and make this cause bigger and stronger with efforts and wisdom.

LUBAN·CABIN

05 | ORGANIZATIONAL STRUCTURE

LUBAN CABIN

Enterprise team

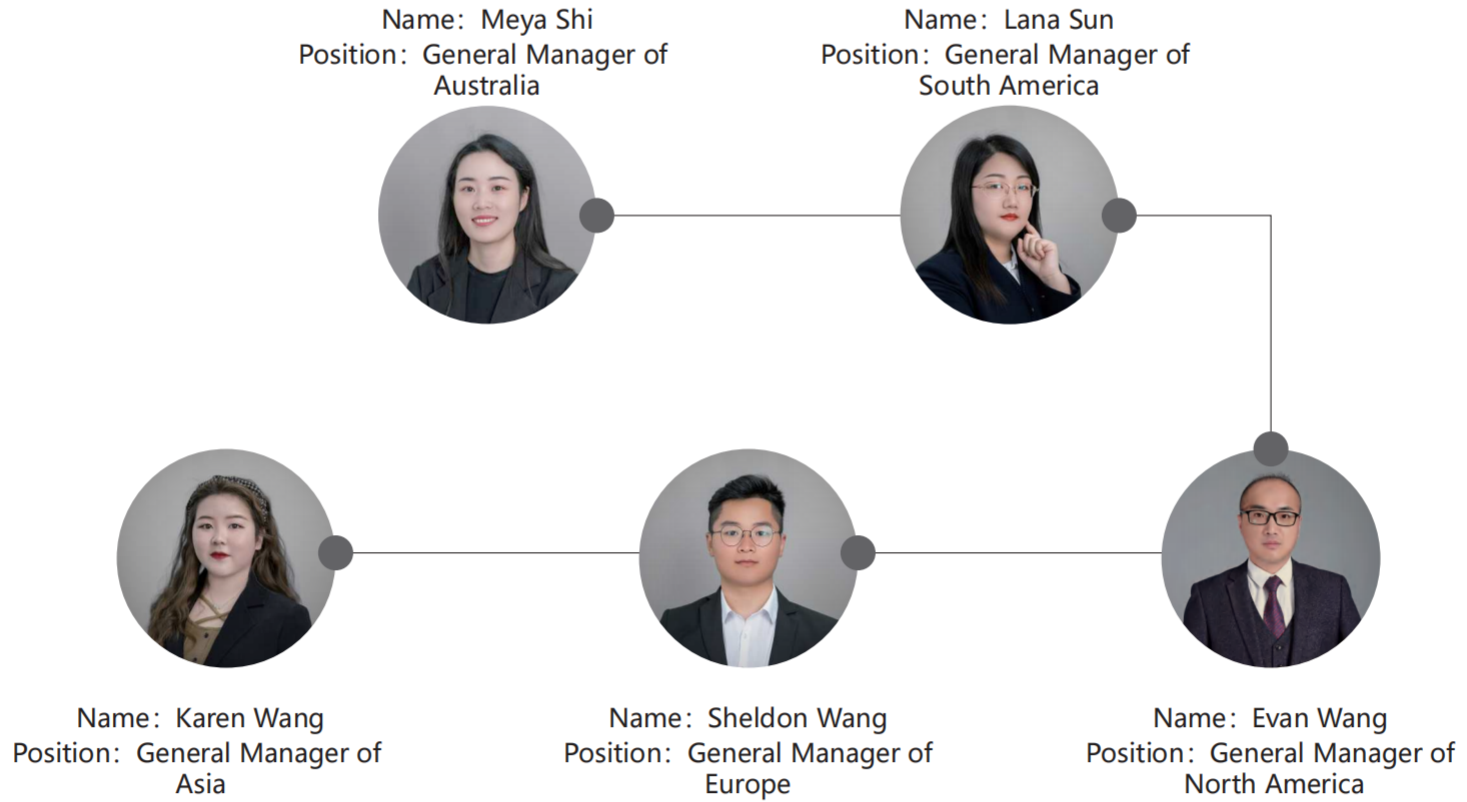

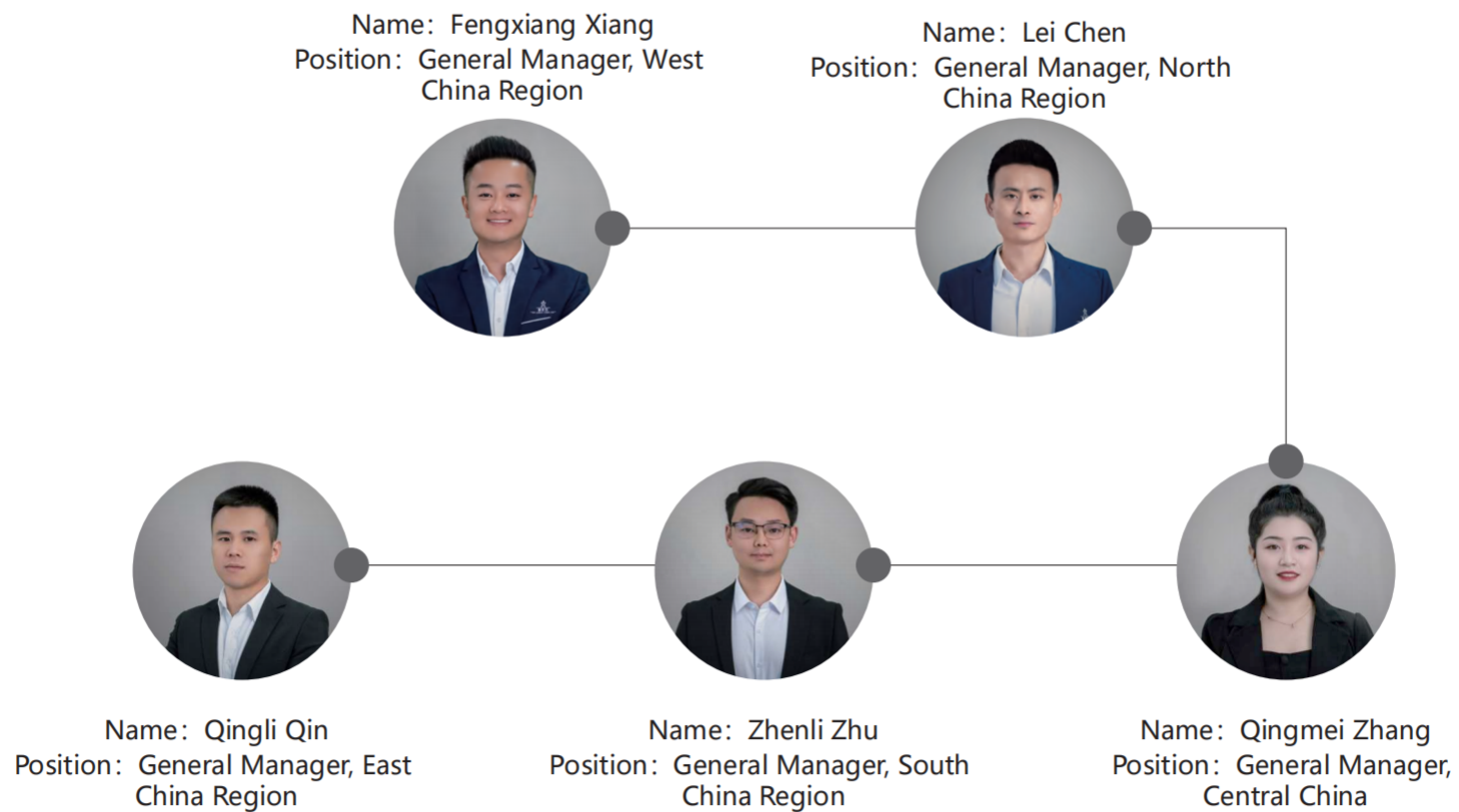

05 | ORGANIZATIONAL STRUCTURE

LUBAN·CABIN

Enterprise team

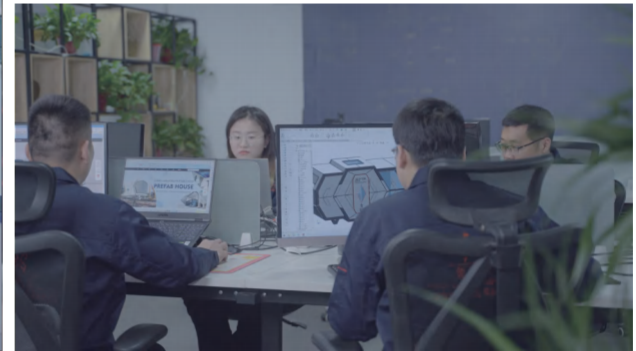

Luban Cabin has a professional design and production team, the technical team controls the product from research and development to landing strictly. So far, it has developed and produced Starship, Nebula, Star Map, Constellation and other series products. The design department insists on starting from a professional point of view, innovative research and development of future cabin products with both aesthetics and practicality products, and implement this concept in the work.

PRODUCT
DEVELOPMENT PERSONNEL

70⁺

TECHNICAL
SUPPORT

200⁺

PROMOTER

30⁺

MARKETERS

300⁺

Zhongbao Huang

LUBAN CABIN CHIEF DESIGNER

Zhongbao Huang is a member of the company's core team and the head of the design department , with many years of design experience and visual communication ability.He is able to conceptualize and create high quality design solutions. Good at combining beauty and functionality, endue unique personality and high-grade appearance to our products.

Xuefang Li

LUBAN CABIN CHIEF ENGINEER

Xuefang Li is the leader of the company's technology department, and his professional field involves the company's products R&D, technical support and maintenance, not only has extensive technical knowledge and rich development experience, but also focus on teamwork and project management,which lays a solid technical foundation for the success of the company's products.

Yuanxiao Qiao

LUBAN CABIN CHIEF BRAND PLANNER

Yuanxiao Qiao is the leader of the brand department of the company and has rich experience in brand planning and marketing. She has an in-depth understanding of the market environment and trends inside and outside the company, insight into market demand and consumer psychology, and can endue our company a strong brand voice and image. She has strong innovative thinking and practical ability in brand positioning, brand communication and brand building,dedicating to make the company's brand stand out of the market brand.

06 | ENTERPRISE HISTORY

LUBAN·CABIN

2003

HONG KONG HUATI GROUP WAS ESTABLISHED

HUADI group have cultural & travel branch (Shandong Endless Landscape Technology Co., Ltd.), building materials branch, cold chain branch, business mixed branch and so on.

2013

SHANDONG ENDLESS LANDSCAPE TECHNOLOGY CO., LTD WAS ESTABLISHED

Our company focuses on supporting equipment in scenic spots: including the large steel structure amusement equipment; the Aircraft, high-speed trains and other large characteristic homestay: the high-end hotels, the scenic camps and other operation plan design, research, development and production.

2016

LUBAN CABIN BRAND WAS ESTABLISHED

In order to comply with national policies, supporting the revival of traditional culture and building ecological cultural tourism, so we founded the intelligent prefabricated building brand--LUBAN CABIN, and began to develop various terrain limited mobile houses.

2017

SETTING UP THE MINISTRY OF FOREIGN TRADE TO GO GLOBAL

Relying on the advantages of logistics capital and the development of heavy industry in the north of China, with the previous successful experience, we have a new advantage to enter the foreign market.

2018

WE HAVE ENTERED THE 2.0 ERA

Our company has a rapid development on the product research and development design, and has achieved proud results, we have officially changed from made in China to intelligent manufacturing in China. our sales team have a rapid expansion, mainly to meet the needs of cultural tourism real estate, core scenic spots, commercial facilities, RV camps and other fields.

2019

OPEN A NEW ERA OF E-COMMERCE

We delve deeply into our products to accelerate e-commerce marketing, through continuous innovation and sales to guide production, so we successfully built the electric commodity brand of LUBAN CABIN, we constantly won overseas orders, and won more than 500 customers in the 30 provinces and cities of the domestic industry.

2020

BREAKTHROUGH-WINNING MORE THAN 130 PATENTS

Our company has obtained more than 130 product invention patents, use new patents and appearance patents. we has established a group model, and innovated the operation management system, and constantly improved various functional departments, such as design, research and development, procurement, operation and customer service.

2021

WE HAVE ENTERED THE 3.0 ERA (WE HAVE BEEN RATED AS A HIGH-TECH ENTERPRISE IN LINYI CITY)

Our company took advantage of the "the 14th Five-Year Plan" as an opportunity and made steady progress. With the encouragement and support of the government, we continue to improve innovation capabilities, by increasing research and development investment, and continuing to improve the ability of independent innovation. we have achieved a good international reputation.

2023

BECOMING THE ONLY COMPANY IN CHINA TO OBTAIN EU CERTIFICATION

After updating and iterating, Luban-zhu Future Capsule has become the only enterprise in China that has obtained the EU certification and the first company whose products have passed the government quality inspection certification.

INTEGRATED PRODUCTION OF ADVANCED EQUIPMENT ASSEMBLY LINE

In terms of product technology, our company has the ISO9001, international SGS, CE and other certifications, and passing the TUV field inspection, product structure safety test, In addition, we have the product invention patents,

FACTORY IMAGE



17 AUTOMATED
PRODUCTION LINES

17⁺

200000+ SQUARE
METERS OF FACTORY

200000⁺

PRODUCE 300+
UNITS PER MONTH

200⁺

3 DAYS FOR SAMPLE PRODUCTION
10 DAYS FOR DELIVERY COMPLETION

3, 10^{days}

08 | QUALIFICATION CERTIFICATE

LUBAN CABIN



37 PATENTS GRANTED

17 DESIGN PATENTS GRANTED

30 UTILITY MODEL PATENTS GRANTED

13 SOFTWARE COPYRIGHTS REGISTERED

TRADEMARK REGISTRATION CERTIFICATE

Luban cabin pays attention to trademark protection, We will safeguard the legitimate rights and interests of consumers and enterprises.

GOVERNMENT QUALITY INSPECTION CERTIFICATION

Luban cabin is the first company in China to obtain the government quality inspection report.

CE STEEL STRUCTURE CERTIFICATE

Product quality in line with export certification, exports to Canada, New Zealand, Australia and other countries.

MULTIPLE PATENT CERTIFICATES

Up to 130 different patent certificates, Invest a lot of energy and funds to produce advanced equipment for inventing the hotel industry.

Shandong Endless Landless Technology Co., LTD., founded in 2013, mainly do large steel structure buildings, high-end hotels, guest rooms design, research and development and production, the company has R & D, design, manufacturing and scene application and other comprehensive capabilities, independent research and development of ultra-low water, electricity, heating energy consumption system, to cope with resource shortage scenic spots. Product core warranty 30 years,

130+EXISTING
PATENT CERTIFICATE

130⁺

ANNUAL RESEARCH INVESTMENT
OF 8 MILLION RMB

500W⁺

PRODUCT R & D
STAFF 70+

70⁺

MORE THAN 30 INDEPENDENT
RESEARCH AND DEVELOPMENT PROJECTS

30⁺

09

PRODUCTION ADVANTAGE

LUBERICABIN



STRICT STANDARD

01

Strictly control the selection of materials, construction projects, the service indicators are strictly abide by the industry standards, emergency equipment is complete, perfect measures, so that customers are more at ease, more assured.

STRENGTHEN QUALITY INSPECTION

02

Attach importance to quality, strengthen quality inspection, from product development to landing, every step is concerned about quality control, through a number of quality inspections of products, establish a good reputation.

HIGH AND NEW TECHNOLOGY

03

Company has gathered high-tech talents in product research and development, camp planning and consulting, landscape planning, industrial design, interior design, machining and other fields.

1. WIND PRESSURE CAN REACH 9

The outer doors and windows are not damaged under the action of wind pressure when they are normally closed. The high strength columns, beams, walls and other load-bearing constructions further resist the impact of wind pressure and vibration.

2. ANTI-CORROSION AND ANTI-INSECT

The external aluminum alloy material has great corrosion resistance. The material has been specially treated, with good airtightness, mosquito, insect and termite proof, and the service life is up to 50 years.

3. FIRE AND WATERPROOF

The wall is made of waterproof coil and waterproof material, and the watertight performance can reach level 6 strong wind and rainstorm. The wall is made of high flame retardant sheet to increase the ability of fire and waterproof.

4. THERMAL INSULATION UP TO 8 LEVELS

Warm in winter, cool in summer, comfortable and energy saving, using a variety of materials of the combination wall, forming a thermal insulation structure system, to solve the dual problem of thermal insulation and heat insulation.

5. SOUND INSULATION PERFORMANCE CAN REACH 45 DB

The double glazing and sound insulation materials are used to meet the national standard "Green Building Evaluation Standard" GB50378, aiming to provide a quiet indoor living environment for residents.

6. ANTI-THEFT AND ANTI-FREEZE

Air tightness up to class 8, steel frame, high-strength aluminum hull, reinforced door lock security, guarantee privacy while enjoying the natural beauty of the outside.

1 | STRUCTURAL ANALYSIS

Luban Cabin

Smart theme control light strip

Small living room warm design

Intelligent security code lock

270 degree view bedroom

High-tech explosion-proof glass

Smart viewing skylight

Sloping roof

360 degree double view balcony



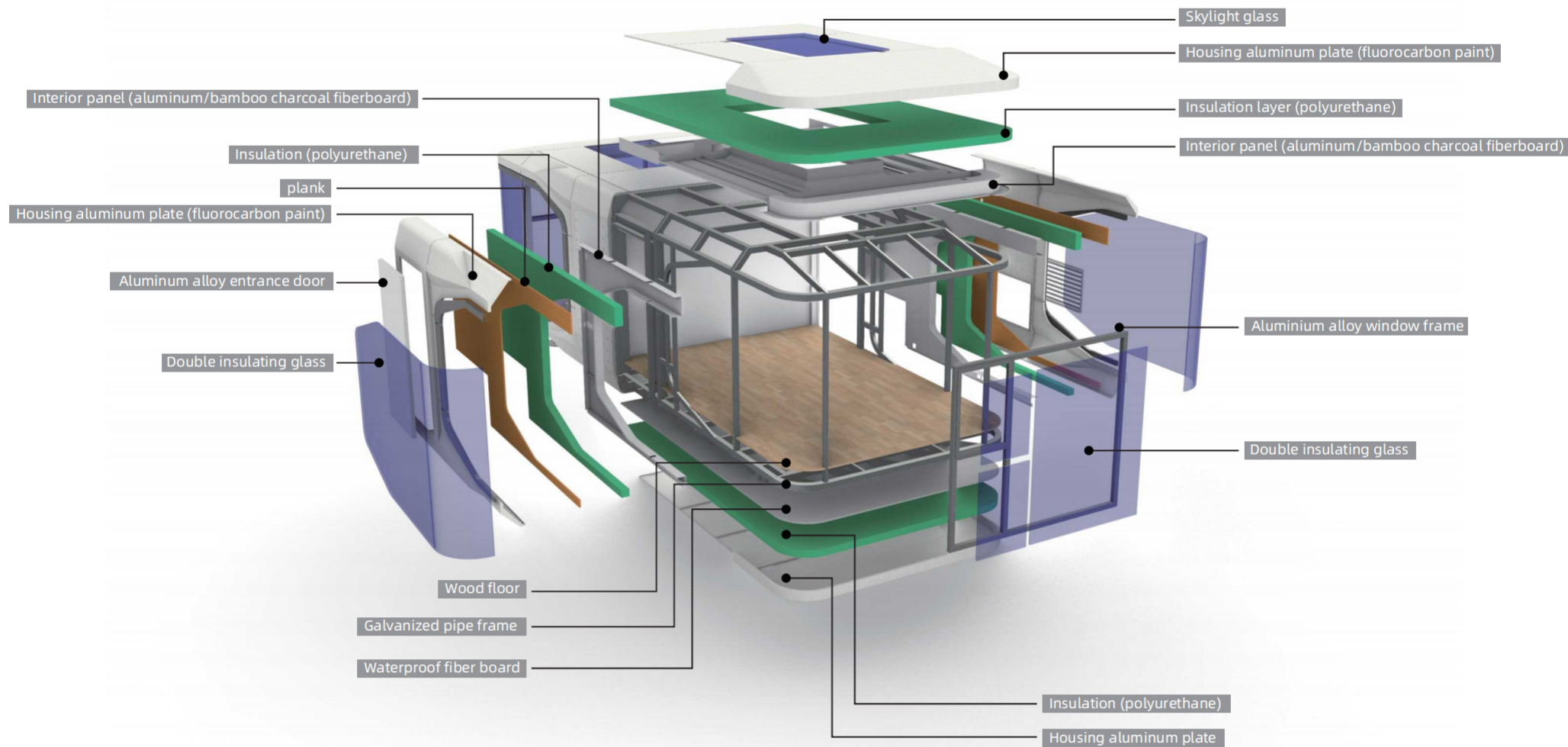

INTERNAL STRUCTURE ANALYSIS DIAGRAM

12 | AI INTELLIGENCE SYSTEM

LUBAN·CABIN



STANDARD FUNCTION

- 1 Intelligent control panel
- 2 Integrated sound system
- 3 Ceiling light belt
- 4 Ambiance light belt
- 5 Simple bar
- 6 Air conditioner
- 7 Ground floodlight belt
- 8 window frame lighting belt
- 9 Automatic curtain
- 10 Fresh air



OPTIONAL FUNCTION

- 11 Panoramic electric atomized glass
- 12 Electric floor heating
- 13 Skylight (with curtain)
- 14 Automatic projection screen

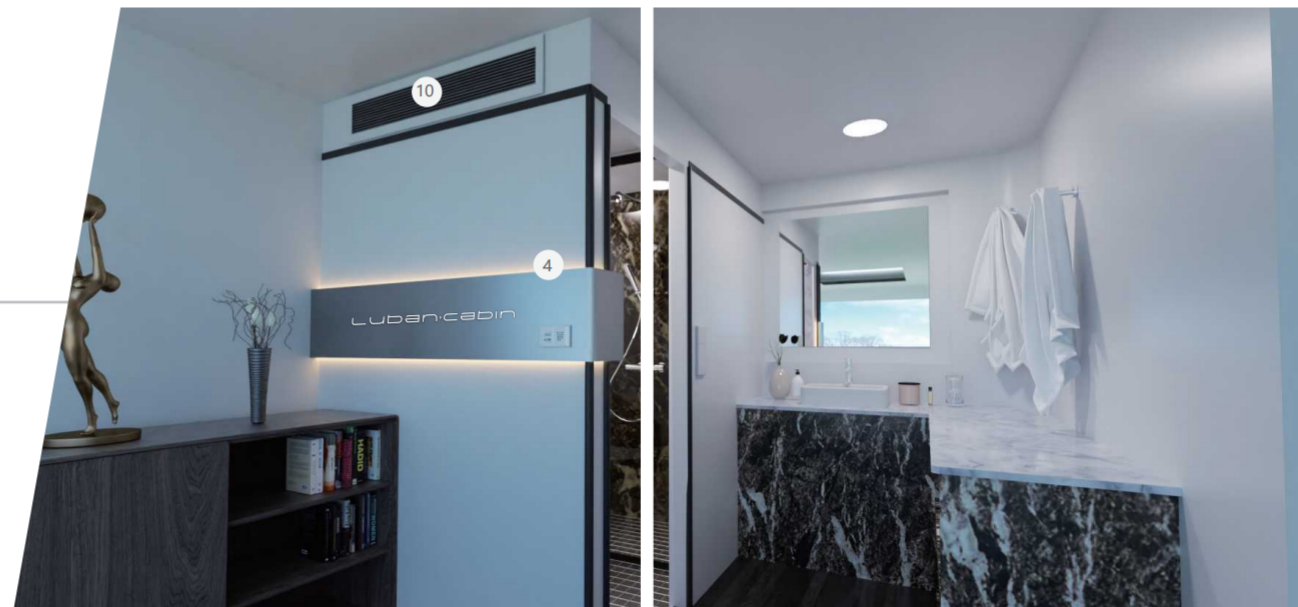

12 | AI INTELLIGENCE SYSTEM

LUBAN·CABIN

CROSS-BORDER INTEGRATION

Provide the overall solution of intelligent integrated equipment./



REMOTE CONTROL

Whole-house smart home system,
、 The mobile APP can be remotely controlled.

INTELLIGENT UPGRADE

Traditional guest room hardware intelligent upgrade and intelligent AI customer service, Help hotels reduce costs and increase efficiency to improve guest experience.





MULTIFACETED SYSTEM CONSTRUCTION

A system to solve hotel communication and enablement problems, Unified management background, convenient and fast

PRECISION DATA COLLECTION

Regularly help the hotel intelligent collection of data, for the hotel to continue to optimize the way of operation and maintenance to provide data support. Background automatic calculation of total revenue, cost, gross profit, financial more worry.



OTA ONLINE UPGRADE
CLOUD-BASED ONLINE PERFECT UPGRADE SYSTEM,
REDUCING MAINTENANCE AND INSPECTION COSTS

13 | PRODUCT CATALOGUE

LUBARICABIN



STARSKY SERIES K30

K30 : L : 5.85 M W : 3M H : 3.1M P:37



STARSKY SERIES K50

K50 : L : 8.5 M W : 3.3M H : 3.3M P:39



STARSKY SERIES K70

K70 : L : 11.5 M W : 3.3M H : 3.3M 41

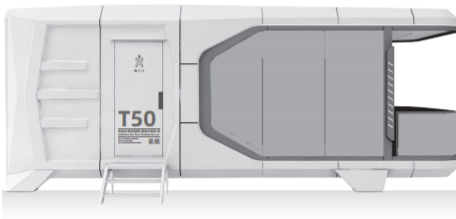

STARSHIP SERIES T50

T50 : L : 8.5 M W : 3.3M H : 3.3M P:43



STARSHIP SERIES X50

X50 : L : 8.5 M W : 3.3M H : 3.3M P:45

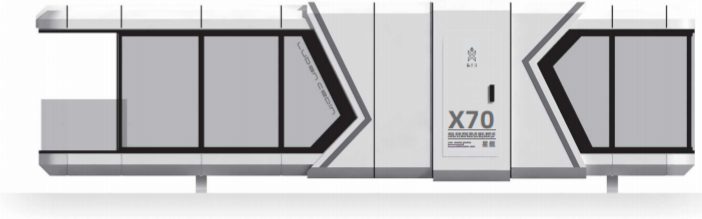

STARSHIP SERIES X70

X70 : L : 11.5 M W : 3.3M H : 3.3M P:47



STARCLOUD SERIES **C30**

C30 : L : 6.6 M W : 3M H : 3.1M P:49



CONSTELLATION **M50**

M50 : L : 8 M W : 3.3M H : 3.2M P:51



STARBLUE SERIES **M30**

M30 : L : 6.3 M W : 3M H : 3.3M P:53

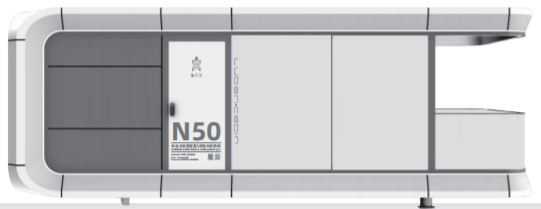

STARCLOUD SERIES **N50**

N50 : L : 8.5 M W : 3.3M H : 3.3M P:55

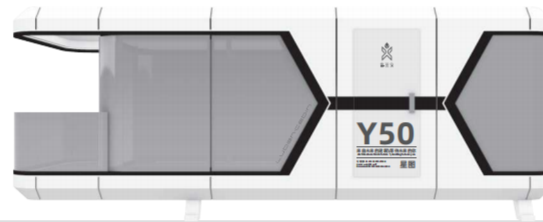

STARMAP SERIES **Y50**

Y50 : L : 8.5 M W : 3.3M H : 3.3M

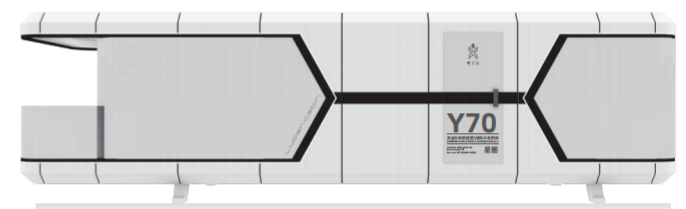

STARMAP SERIES **Y70**

Y70 : L : 11.5 M W : 3.3M H : 3.3M

13 | **PRODUCT CATALOGUE**
 LUBARICABIN

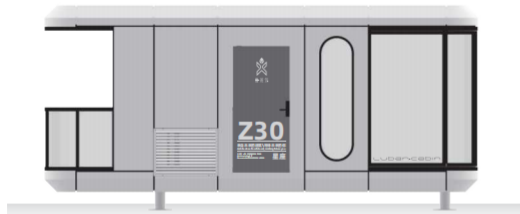

CONSTELLATION Z30

Z30 : L : 7 M W : 3M H : 3.3M



STARLIGHT SERIES E50

E50 : L : 5.8 M W : 2.15M H : 2.5M P:58



STARLIGHT SERIES E30

E30 : L : 3.85M W : 2.15M H : 2.5M P:57



STARLIGHT SERIES E70

E70 : L : 11.5 M W : 2.15M H : 2.5M P:59



STARLIGHT SERIES D50

E50 : L : 5.8 M W : 2.15M H : 2.5M P:60



STARCIRCLE SERIES **U30**

U30 : L : 3.6M W : 3.6M H : 2.7M P:61



STARGALABY SERIES **FH30**

FH30 : L : 6.5M W : 3.5M H : 3.3M P:63



STARGALABY SERIES **FH60**

FH60 : L : 8.5M W : 3.5M H : 3.3M P:64



STARGALABY SERIES **FH90**

FH90 : L : 11.5M W : 3.5M H : 3.3M P:65

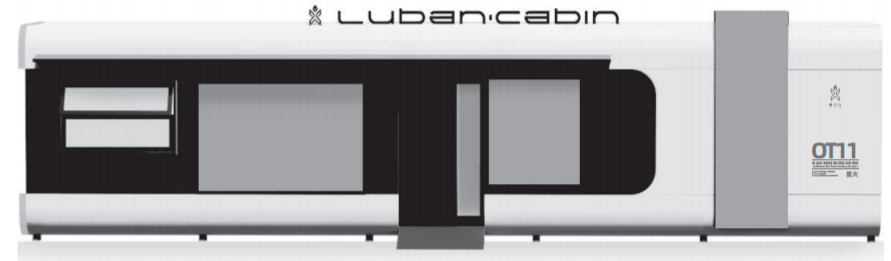

STARFIRE SERIES **OT11**

OT11 : L : 12M W : 2.4M H : 3M P:67



STARFIRE SERIES **OT40**

OT40 : L : 12M W : 2.4M H : 3M P:70



STARFIRE SERIES **OT50**

OT50 : L : 12M W : 2.4M H : 3M P:70



STARFIRE SERIES **OT80**

OT80 : L : 12M W : 2.4M H : 3M P:70



STARFIRE SERIES **OT90**

OT90 : L : 12M W : 2.4M H : 3M P:70

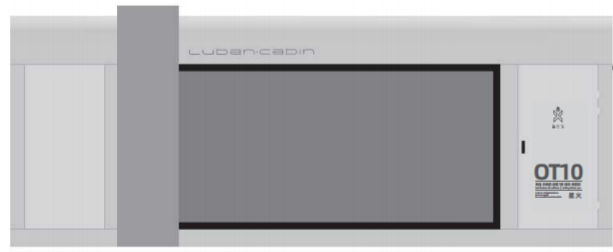

STARFIRE SERIES OT10

OT10 : L : 12M W : 2.4M H : 3M P:70



STARFIRE SERIES OT30

OT30 : L : 12M W : 2.4M H : 3M P:70

Customized OEM
(Original Equipment Manufacturer)

- Color standard housing module
- Standard interior module
- Standard cabinet module
- Environment-friendly composite floor module

No one knows you like we do.

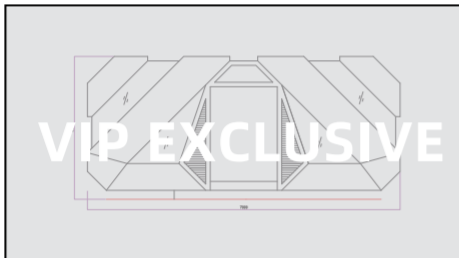

VIP EXCLUSIVE

STAR ORBIT Q50

Q50 : L : 8.5 M W : 3.3M H : 3M

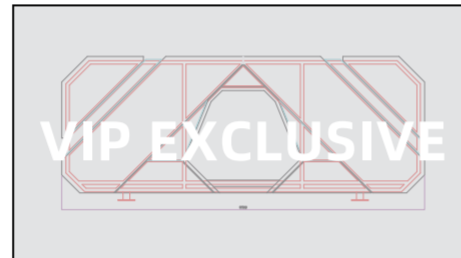

VIP EXCLUSIVE

STAR ORBIT Q70

Q70 : L : 8.5 M W : 3.3M H : 3M

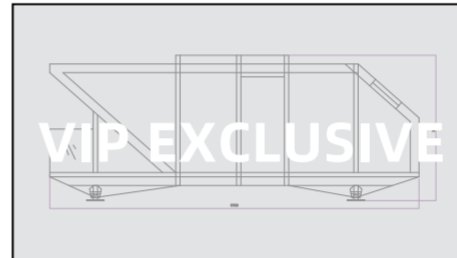

VIP EXCLUSIVE

STAR TRACK H50

H50 : L : 8.5 M W : 3.3M H : 3M

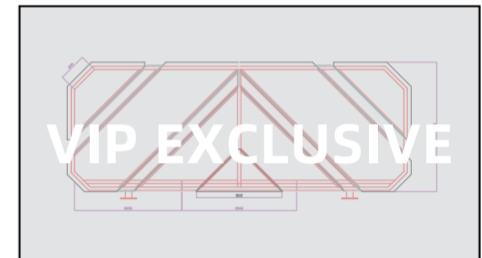

VIP EXCLUSIVE

STAR TRACK H70

H70 : L : 8.5 M W : 3.3M H : 3M

Domestic version



Export Version

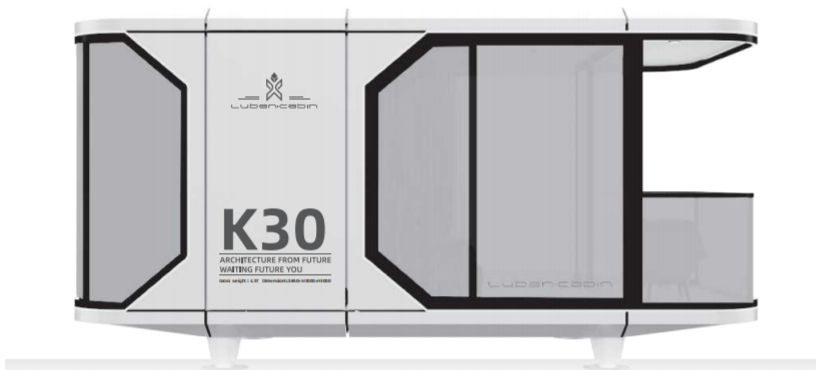

K30

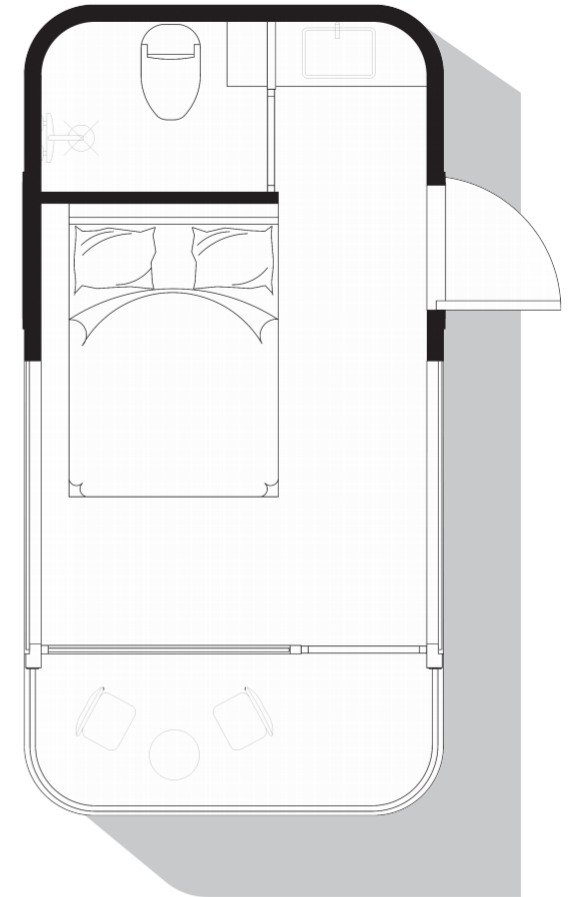

14 | PRODUCT SHOWCASE | K30

LUBAR·CABIN

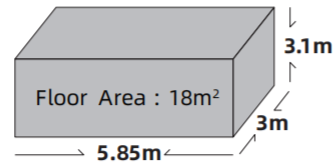

MAIN STRUCTURE:	Thickened steel frame, aluminum exterior panels, polyurethane insulation layer, panoramic wall curtain glass (6+12+6 insulating glass), aluminum doors and Windows, intelligent access control, foot support.
INTERNAL STRUCTURE:	Bamboo charcoal fiberboard wall, advanced waterproof composite wood floor, indoor and outdoor multi-color warm light, electric curtain, large skylight, the whole house intelligent control system, brand socket panel.
SANITARY WARE:	Glass side sliding door, smart toilet, water heater, shower, brand basin, brand faucet.
MAIN EQUIPMENT:	Gree central air conditioning, water heater, bath ba wind heating multi-in-one integrated bath ba.
OPTIONAL:	Electric floor heating, water pipe antifreeze, projector, fire smoke alarm, starry roof.



PRIMARY MANUSCRIPT

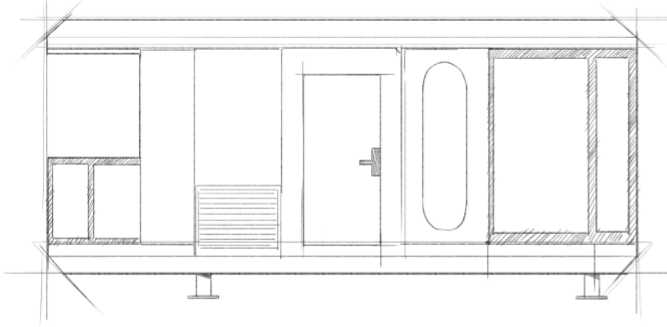

FIRST GENERATION

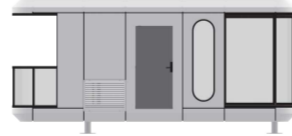

SECOND GENERATION

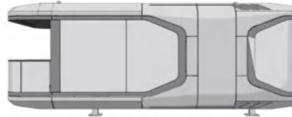

NEW THIRD GENERATION



Domestic version



Export Version

K50

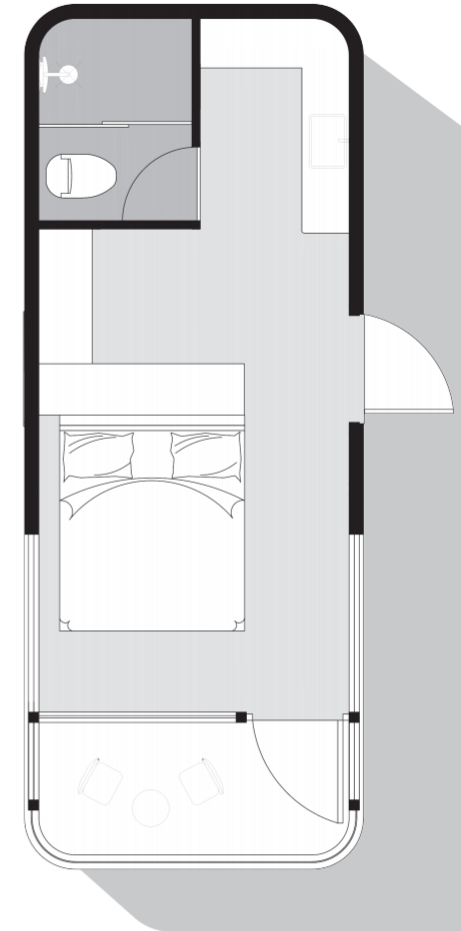

14 | PRODUCT SHOWCASE | K50
LUBAN·CABIN

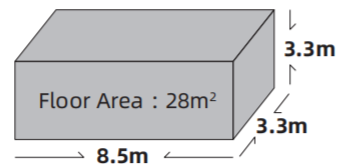

MAIN STRUCTURE:	Thickened steel frame, aluminum exterior panels, polyurethane insulation layer, panoramic wall curtain glass (6+12+6 insulating glass), aluminum doors and Windows, intelligent access control, foot support.
INTERNAL STRUCTURE:	Bamboo charcoal fiberboard wall, advanced waterproof composite wood floor, indoor and outdoor multi-color warm light, electric curtain, large skylight, the whole house intelligent control system, brand socket panel.
SANITARY WARE:	Glass side sliding door, smart toilet, water heater, shower, brand basin, brand faucet.
MAIN EQUIPMENT:	Gree central air conditioning, water heater, bath ba wind heating multi-in-one integrated bath ba.
OPTIONAL:	Electric floor heating, water pipe antifreeze, projector, fire smoke alarm, starry roof.



PRIMARY MANUSCRIPT

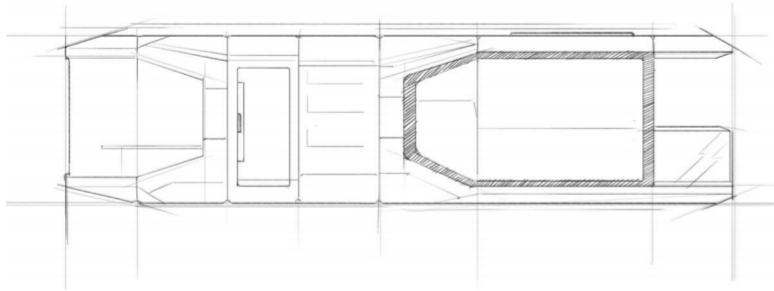

FIRST GENERATION

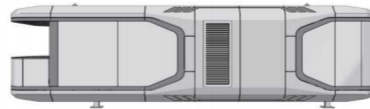

SECOND GENERATION

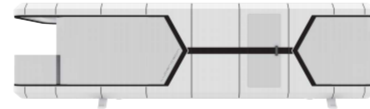

NEW THIRD GENERATION



Domestic version



Export Version



K70

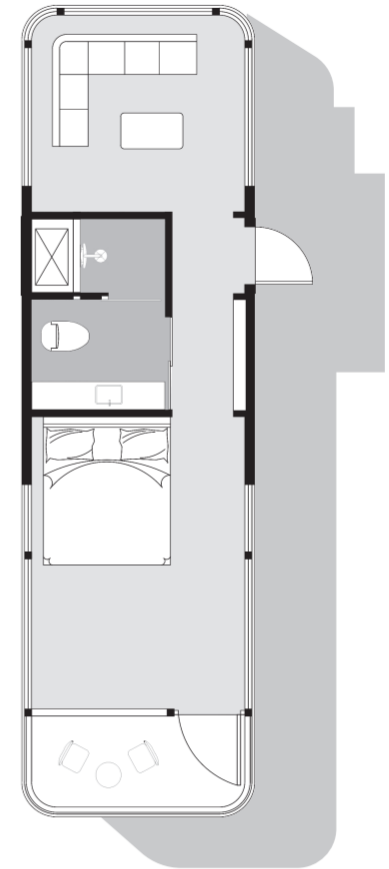

14 | PRODUCT SHOWCASE | K70

LUBAN·CABIN

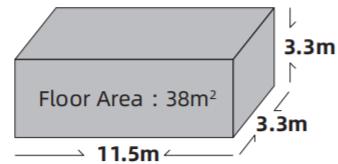

MAIN STRUCTURE:	Thickened steel frame, aluminum exterior panels, polyurethane insulation layer, panoramic wall curtain glass (6+12+6 insulating glass), aluminum doors and Windows, intelligent access control, foot support.
INTERNAL STRUCTURE:	Bamboo charcoal fiberboard wall, advanced waterproof composite wood floor, indoor and outdoor multi-color warm light, electric curtain, large skylight, the whole house intelligent control system, brand socket panel.
SANITARY WARE:	Glass side sliding door, smart toilet, water heater, shower, brand basin, brand faucet.
MAIN EQUIPMENT:	Gree central air conditioning, water heater, bath ba wind heating multi-in-one integrated bath ba.
OPTIONAL:	Electric floor heating, water pipe antifreeze, projector, fire smoke alarm, starry roof.



Domestic version



Export Version

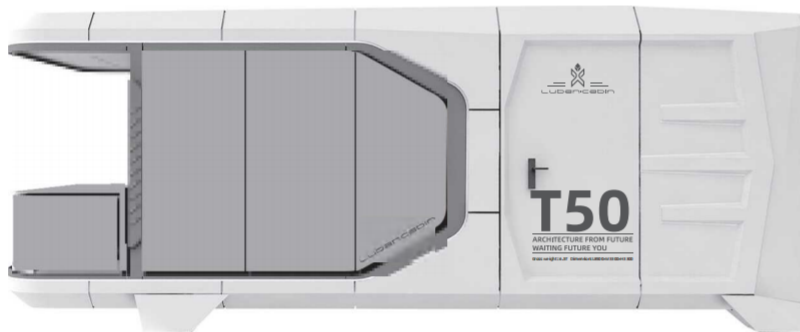

T50

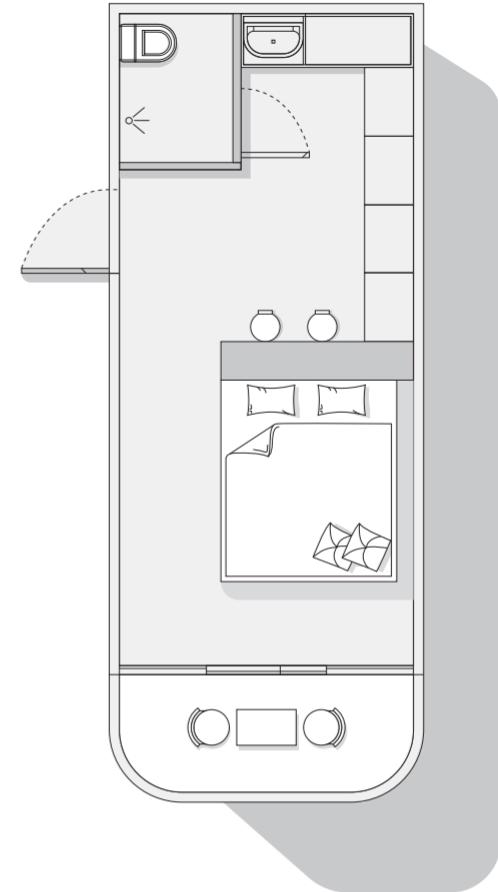

14 | PRODUCT SHOWCASE | T50
LUBAN·CABIN

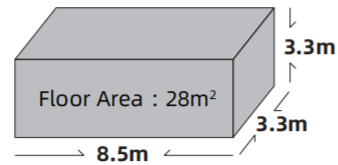

MAIN STRUCTURE:	Thickened steel frame, aluminum exterior panels, polyurethane insulation layer, panoramic wall curtain glass (6+12+6 insulating glass), aluminum doors and Windows, intelligent access control, foot support.
INTERNAL STRUCTURE:	Bamboo charcoal fiberboard wall, advanced waterproof composite wood floor, indoor and outdoor multi-color warm light, electric curtain, large skylight, the whole house intelligent control system, brand socket panel.
SANITARY WARE:	Glass side sliding door, smart toilet, water heater, shower, brand basin, brand faucet.
MAIN EQUIPMENT:	Gree central air conditioning, water heater, bath ba wind heating multi-in-one integrated bath ba.
OPTIONAL:	Electric floor heating, water pipe antifreeze, projector, fire smoke alarm, starry roof.



Domestic version

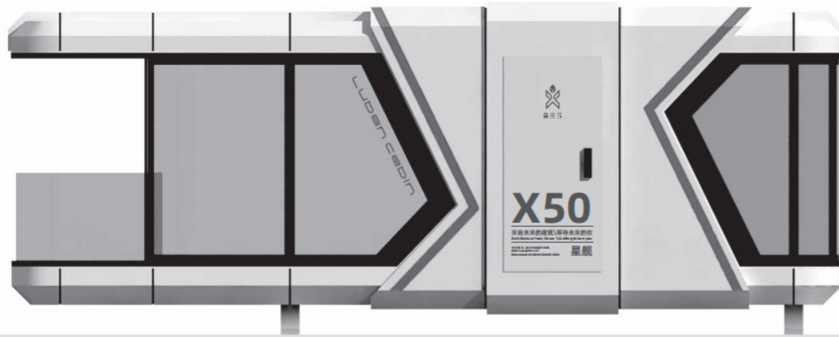

Export Version

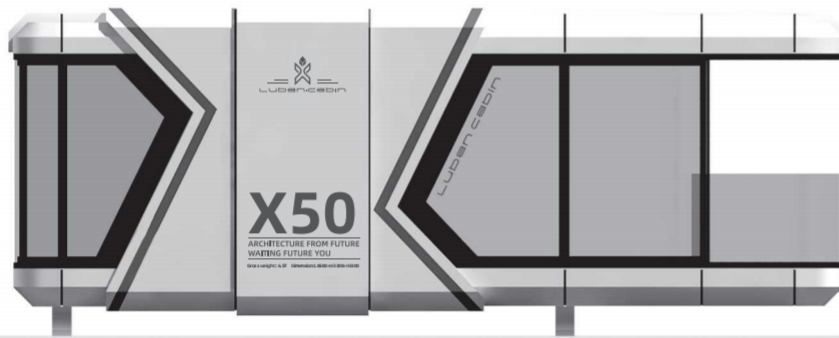

X50

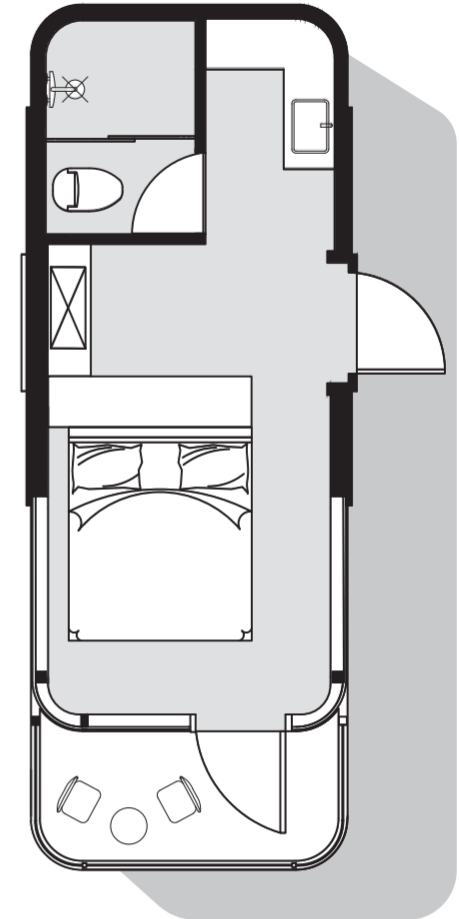

14 | PRODUCT SHOWCASE | X50
LUBAN·CABIN

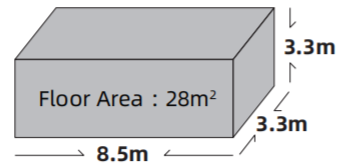

MAIN STRUCTURE:	Thickened steel frame, aluminum exterior panels, polyurethane insulation layer, panoramic wall curtain glass (6+12+6 insulating glass), aluminum doors and Windows, intelligent access control, foot support.
INTERNAL STRUCTURE:	Bamboo charcoal fiberboard wall, advanced waterproof composite wood floor, indoor and outdoor multi-color warm light, electric curtain, large skylight, the whole house intelligent control system, brand socket panel.
SANITARY WARE:	Glass side sliding door, smart toilet, water heater, shower, brand basin, brand faucet.
MAIN EQUIPMENT:	Gree central air conditioning, water heater, bath ba wind heating multi-in-one integrated bath ba.
OPTIONAL:	Electric floor heating, water pipe antifreeze, projector, fire smoke alarm, starry roof.



Domestic version

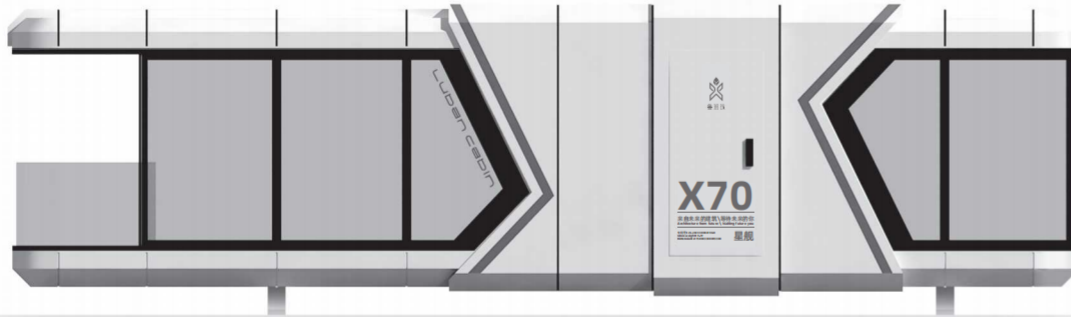

Export Version



X70

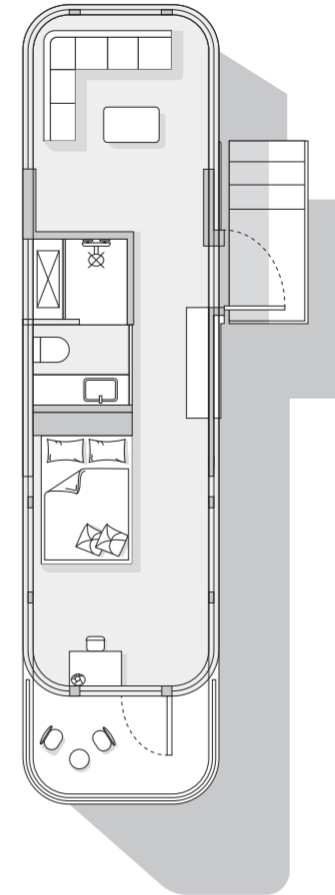

14 | PRODUCT SHOWCASE | X70
Luban·cabin

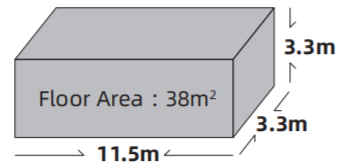

MAIN STRUCTURE:	Thickened steel frame, aluminum exterior panels, polyurethane insulation layer, panoramic wall curtain glass (6+12+6 insulating glass), aluminum doors and Windows, intelligent access control, foot support.
INTERNAL STRUCTURE:	Bamboo charcoal fiberboard wall, advanced waterproof composite wood floor, indoor and outdoor multi-color warm light, electric curtain, large skylight, the whole house intelligent control system, brand socket panel.
SANITARY WARE:	Glass side sliding door, smart toilet, water heater, shower, brand basin, brand faucet.
MAIN EQUIPMENT:	Gree central air conditioning, water heater, bath ba wind heating multi-in-one integrated bath ba.
OPTIONAL:	Electric floor heating, water pipe antifreeze, projector, fire smoke alarm, starry roof.



Domestic version



Export Version



C30

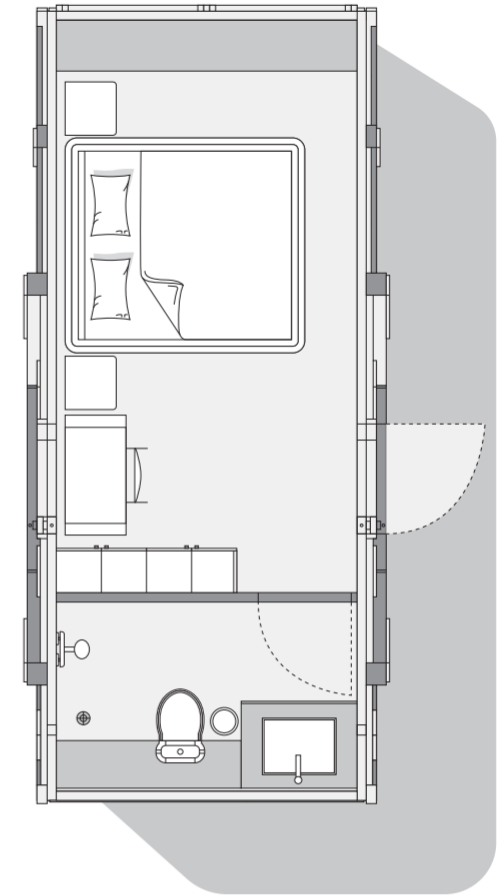

14 | PRODUCT SHOWCASE | C30
LUBAN·CABIN

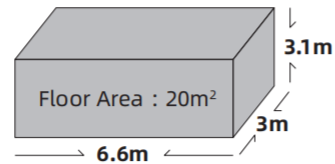

MAIN STRUCTURE:	Thickened steel frame, aluminum exterior panels, polyurethane insulation layer, panoramic wall curtain glass (6+12+6 insulating glass), aluminum doors and Windows, intelligent access control, foot support.
INTERNAL STRUCTURE:	Bamboo charcoal fiberboard wall, advanced waterproof composite wood floor, indoor and outdoor multi-color warm light, electric curtain, large skylight, the whole house intelligent control system, brand socket panel.
SANITARY WARE:	Glass side sliding door, smart toilet, water heater, shower, brand basin, brand faucet.
MAIN EQUIPMENT:	Gree central air conditioning, water heater, bath ba wind heating multi-in-one integrated bath ba.
OPTIONAL:	Electric floor heating, water pipe antifreeze, projector, fire smoke alarm, starry roof.



Domestic version



Export Version



M50

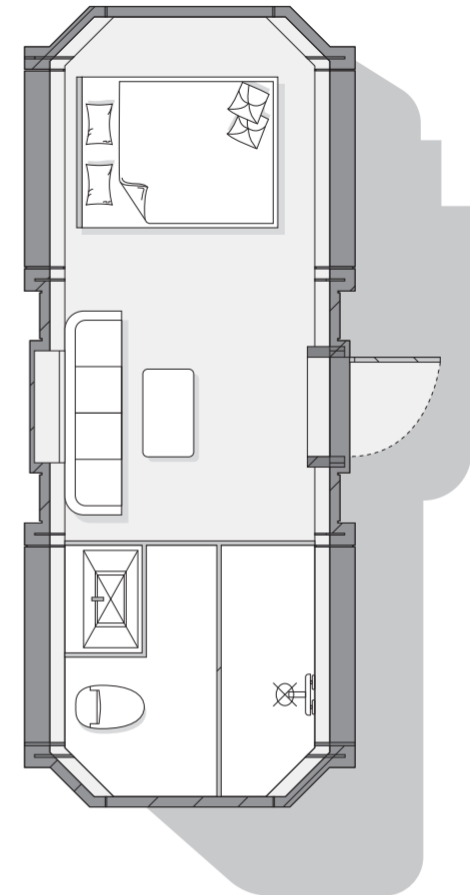

14 | PRODUCT SHOWCASE | M50
LUBAN·CABIN

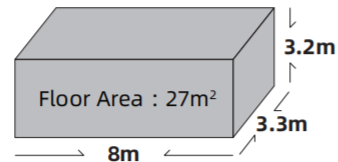

MAIN STRUCTURE:	Thickened steel frame, aluminum exterior panels, polyurethane insulation layer, panoramic wall curtain glass (6+12+6 insulating glass), aluminum doors and Windows, intelligent access control, foot support.
INTERNAL STRUCTURE:	Bamboo charcoal fiberboard wall, advanced waterproof composite wood floor, indoor and outdoor multi-color warm light, electric curtain, large skylight, the whole house intelligent control system, brand socket panel.
SANITARY WARE:	Glass side sliding door, smart toilet, water heater, shower, brand basin, brand faucet.
MAIN EQUIPMENT:	Gree central air conditioning, water heater, bath ba wind heating multi-in-one integrated bath ba.
OPTIONAL:	Electric floor heating, water pipe antifreeze, projector, fire smoke alarm, starry roof.



Domestic version



Export Version



M30

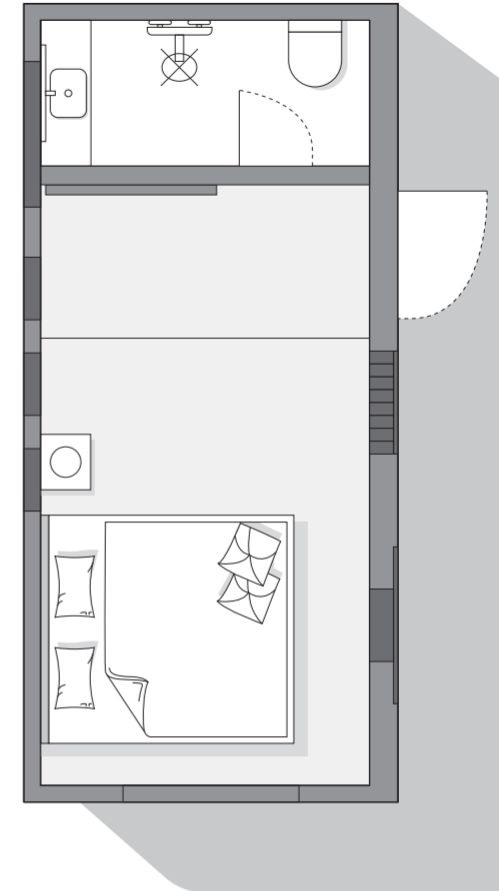

14 | PRODUCT SHOWCASE | M30
LUBAN·CABIN

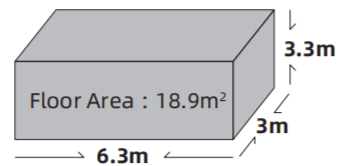

MAIN STRUCTURE:	Thickened steel frame, aluminum exterior panels, polyurethane insulation layer, panoramic wall curtain glass (6+12+6 insulating glass), aluminum doors and Windows, intelligent access control, foot support.
INTERNAL STRUCTURE:	Bamboo charcoal fiberboard wall, advanced waterproof composite wood floor, indoor and outdoor multi-color warm light, electric curtain, large skylight, the whole house intelligent control system, brand socket panel.
SANITARY WARE:	Glass side sliding door, smart toilet, water heater, shower, brand basin, brand faucet.
MAIN EQUIPMENT:	Gree central air conditioning, water heater, bath ba wind heating multi-in-one integrated bath ba.
OPTIONAL:	Electric floor heating, water pipe antifreeze, projector, fire smoke alarm, starry roof.



Domestic version



Export Version



N50

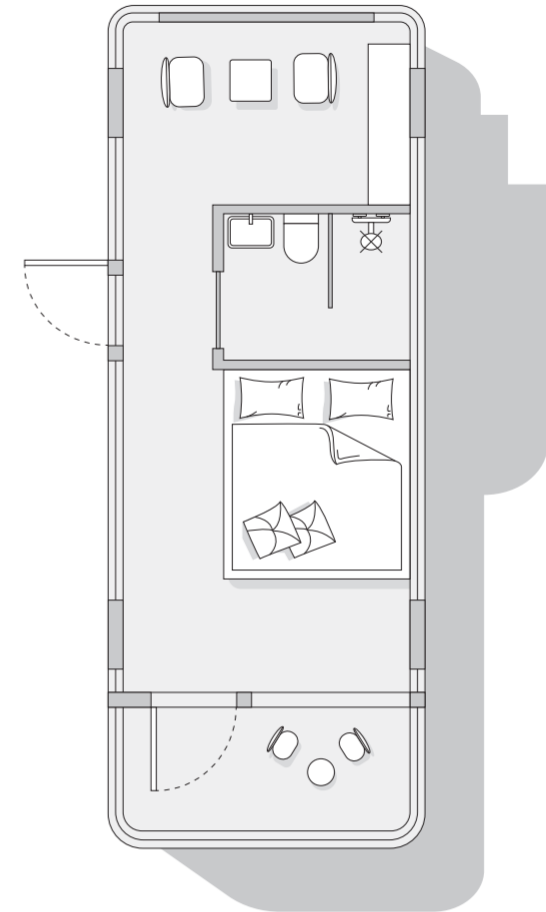

14 | PRODUCT SHOWCASE | N50
LUBAN·CABIN

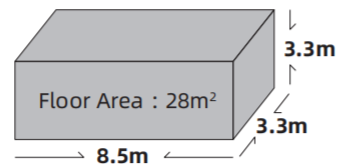

MAIN STRUCTURE:	Thickened steel frame, aluminum exterior panels, polyurethane insulation layer, panoramic wall curtain glass (6+12+6 insulating glass), aluminum doors and Windows, intelligent access control, foot support.
INTERNAL STRUCTURE:	Bamboo charcoal fiberboard wall, advanced waterproof composite wood floor, indoor and outdoor multi-color warm light, electric curtain, large skylight, the whole house intelligent control system, brand socket panel.
SANITARY WARE:	Glass side sliding door, smart toilet, water heater, shower, brand basin, brand faucet.
MAIN EQUIPMENT:	Gree central air conditioning, water heater, bath ba wind heating multi-in-one integrated bath ba.
OPTIONAL:	Electric floor heating, water pipe antifreeze, projector, fire smoke alarm, starry roof.



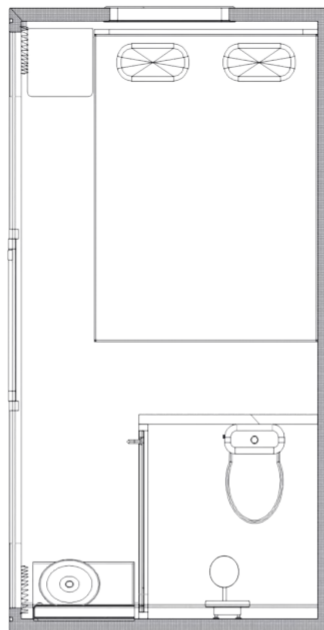
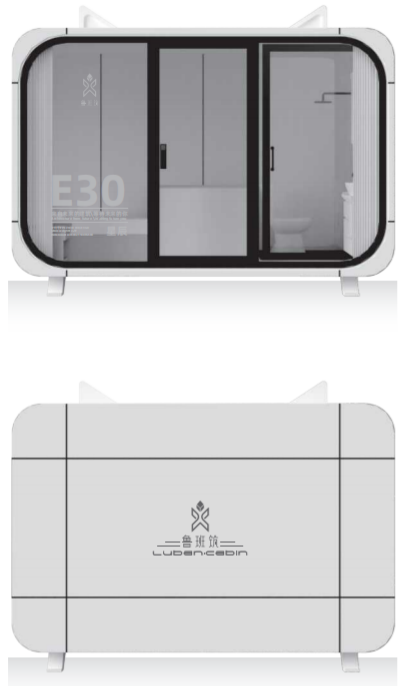

E30



14 | PRODUCT SHOWCASE | E30
LUBAN·CABIN

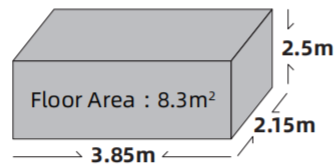

- MAIN STRUCTURE** : Thickened steel frame, aluminum exterior panels, polyurethane insulation layer, panoramic wall curtain glass (6+12+6 insulating glass), aluminum doors and Windows, intelligent access control, foot support.
- INTERNAL STRUCTURE**: Bamboo charcoal fiberboard wall, advanced waterproof composite wood floor, indoor and outdoor multi-color warm light, electric curtain, large skylight, the whole house intelligent control system, brand socket panel.
- SANITARY WARE** : Glass side sliding door, smart toilet, water heater, shower, brand basin, brand faucet.
- MAIN EQUIPMENT** : Gree central air conditioning, water heater, bath ba wind heating multi-in-one integrated bath ba.
- OPTIONAL** : Electric floor heating, water pipe antifreeze, projector, fire smoke alarm, starry roof.



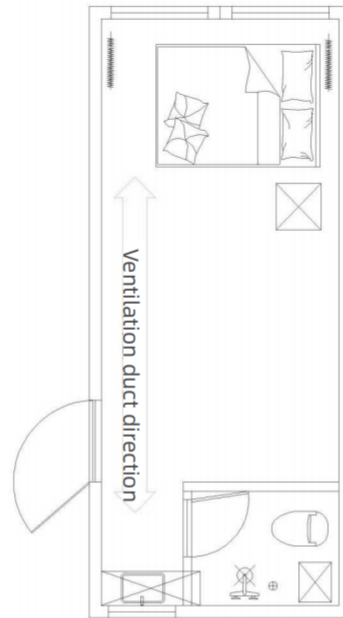
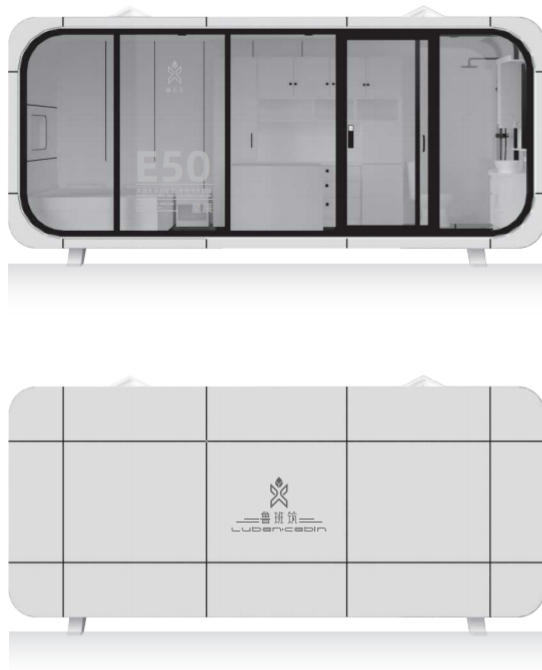

E50



14 | PRODUCT SHOWCASE | E50
Luban·cabin

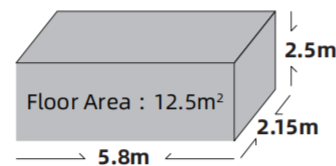

MAIN STRUCTURE	: Thickened steel frame, aluminum exterior panels, polyurethane insulation layer, panoramic wall curtain glass (6+12+6 insulating glass), aluminum doors and Windows, intelligent access control, foot support.
INTERNAL STRUCTURE	: Bamboo charcoal fiberboard wall, advanced waterproof composite wood floor, indoor and outdoor multi-color warm light, electric curtain, large skylight, the whole house intelligent control system, brand socket panel.
SANITARY WARE	: Glass side sliding door, smart toilet, water heater, shower, brand basin, brand faucet.
MAIN EQUIPMENT	: Gree central air conditioning, water heater, bath ba wind heating multi-in-one integrated bath ba.
OPTIONAL	: Electric floor heating, water pipe antifreeze, projector, fire smoke alarm, starry roof.



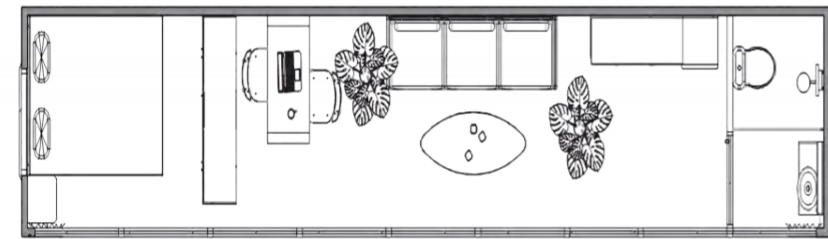

E70



14 | PRODUCT SHOWCASE | E70
LUBAN·CABIN

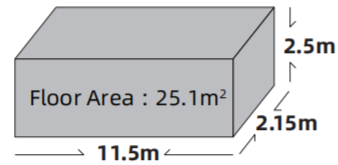

MAIN STRUCTURE : Thickened steel frame, aluminum exterior panels, polyurethane insulation layer, panoramic wall curtain glass (6+12+6 insulating glass), aluminum doors and Windows, intelligent access control, foot support.

INTERNAL STRUCTURE: Bamboo charcoal fiberboard wall, advanced waterproof composite wood floor, indoor and outdoor multi-color warm light, electric curtain, large skylight, the whole house intelligent control system, brand socket panel.

SANITARY WARE : Glass side sliding door, smart toilet, water heater, shower, brand basin, brand faucet.

MAIN EQUIPMENT : Gree central air conditioning, water heater, bath ba wind heating multi-in-one integrated bath ba.

OPTIONAL : Electric floor heating, water pipe antifreeze, projector, fire smoke alarm, stary roof.



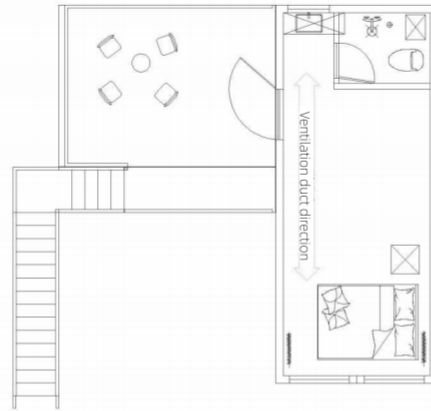

D50



14 | PRODUCT SHOWCASE | D50
Luban·cabin

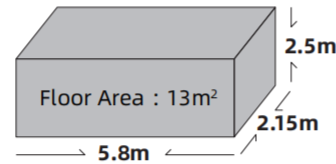

MAIN STRUCTURE : Thickened steel frame, aluminum exterior panels, polyurethane insulation layer, panoramic wall curtain glass (6+12+6 insulating glass), aluminum doors and Windows, intelligent access control, foot support.

INTERNAL STRUCTURE: Bamboo charcoal fiberboard wall, advanced waterproof composite wood floor, indoor and outdoor multi-color warm light, electric curtain, large skylight, the whole house intelligent control system, brand socket panel.

SANITARY WARE : Glass side sliding door, smart toilet, water heater, shower, brand basin, brand faucet.

MAIN EQUIPMENT : Gree central air conditioning, water heater, bath ba wind heating multi-in-one integrated bath ba.

OPTIONAL : Electric floor heating, water pipe antifreeze, projector, fire smoke alarm, starry roof.



Domestic version



Export Version



U30

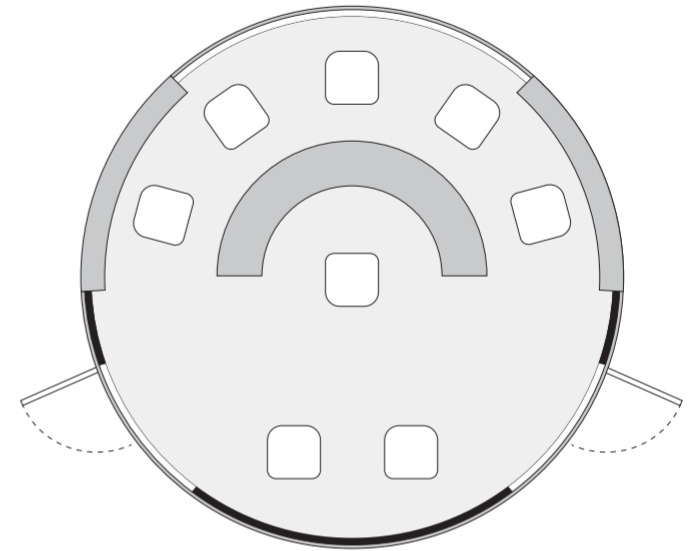

14 | PRODUCT SHOWCASE | U30

LUBAN·CABIN

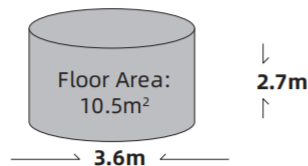

MAIN STRUCTURE:	Thickened steel frame, aluminum exterior panels, polyurethane insulation layer, panoramic wall curtain glass (6+12+6 insulating glass), aluminum doors and Windows, intelligent access control, foot support.
INTERNAL STRUCTURE:	Bamboo charcoal fiberboard wall, advanced waterproof composite wood floor, indoor and outdoor multi-color warm light, electric curtain, large skylight, the whole house intelligent control system, brand socket panel.
SANITARY WARE:	Glass side sliding door, smart toilet, water heater, shower, brand basin, brand faucet.
MAIN EQUIPMENT:	Gree central air conditioning, water heater, bath ba wind heating multi-in-one integrated bath ba.
OPTIONAL:	Electric floor heating, water pipe antifreeze, projector, fire smoke alarm, starry roof.



U30

来自未来的建筑\等待未来的你
Architecture from future \ Waiting future you

专利号: ZL 20233 0004198.0
Gross Weight: 2.5T
Dimension: 1.3850x2.150x 2.400

星園



Domestic version



Export Version



FH30

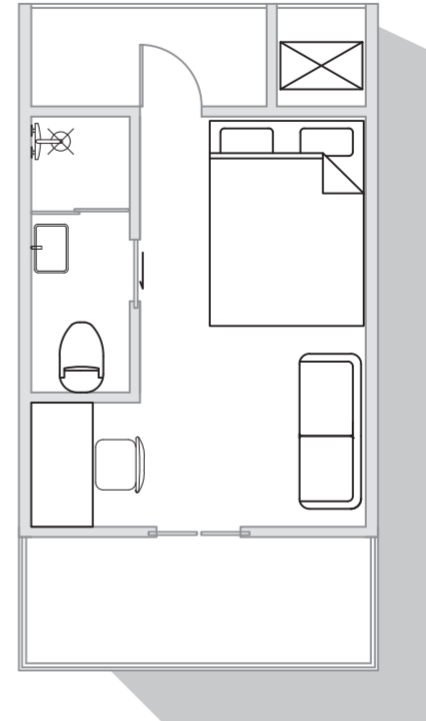

14 | PRODUCT SHOWCASE | FH30
LUBAN·CABIN

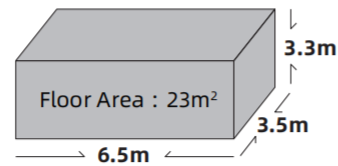

MAIN STRUCTURE:	Thickened steel frame, aluminum exterior panels, polyurethane insulation layer, panoramic wall curtain glass (6+12+6 insulating glass), aluminum doors and Windows, intelligent access control, foot support.
INTERNAL STRUCTURE:	Bamboo charcoal fiberboard wall, advanced waterproof composite wood floor, indoor and outdoor multi-color warm light, electric curtain, large skylight, the whole house intelligent control system, brand socket panel.
SANITARY WARE:	Glass side sliding door, smart toilet, water heater, shower, brand basin, brand faucet.
MAIN EQUIPMENT:	Gree central air conditioning, water heater, bath ba wind heating multi-in-one integrated bath ba.
OPTIONAL:	Electric floor heating, water pipe antifreeze, projector, fire smoke alarm, starry roof.

Domestic version



Export Version



FH60

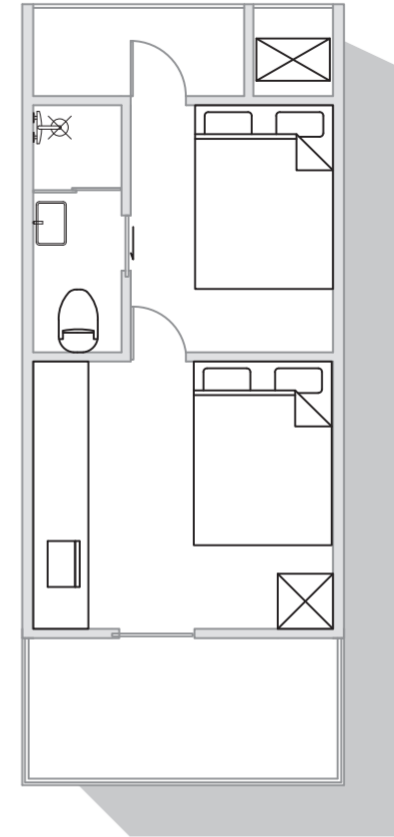

14 | PRODUCT SHOWCASE | FH60
LUBAN·CABIN

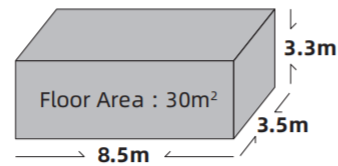

MAIN STRUCTURE:	Thickened steel frame, aluminum exterior panels, polyurethane insulation layer, panoramic wall curtain glass (6+12+6 insulating glass), aluminum doors and Windows, intelligent access control, foot support.
INTERNAL STRUCTURE:	Bamboo charcoal fiberboard wall, advanced waterproof composite wood floor, indoor and outdoor multi-color warm light, electric curtain, large skylight, the whole house intelligent control system, brand socket panel.
SANITARY WARE:	Glass side sliding door, smart toilet, water heater, shower, brand basin, brand faucet.
MAIN EQUIPMENT:	Gree central air conditioning, water heater, bath ba wind heating multi-in-one integrated bath ba.
OPTIONAL:	Electric floor heating, water pipe antifreeze, projector, fire smoke alarm, stary roof.

Domestic version



Export Version



FH90

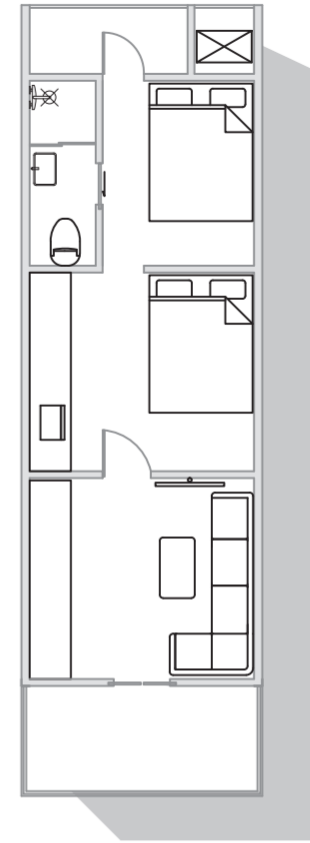

14 | PRODUCT SHOWCASE | FH90
LUBAN·CABIN

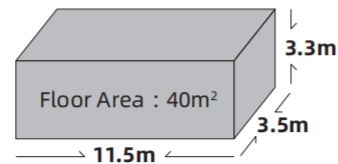

MAIN STRUCTURE:	Thickened steel frame, aluminum exterior panels, polyurethane insulation layer, panoramic wall curtain glass (6+12+6 insulating glass), aluminum doors and Windows, intelligent access control, foot support.
INTERNAL STRUCTURE:	Bamboo charcoal fiberboard wall, advanced waterproof composite wood floor, indoor and outdoor multi-color warm light, electric curtain, large skylight, the whole house intelligent control system, brand socket panel.
SANITARY WARE:	Glass side sliding door, smart toilet, water heater, shower, brand basin, brand faucet.
MAIN EQUIPMENT:	Gree central air conditioning, water heater, bath ba wind heating multi-in-one integrated bath ba.
OPTIONAL:	Electric floor heating, water pipe antifreeze, projector, fire smoke alarm, starry roof.



Domestic version

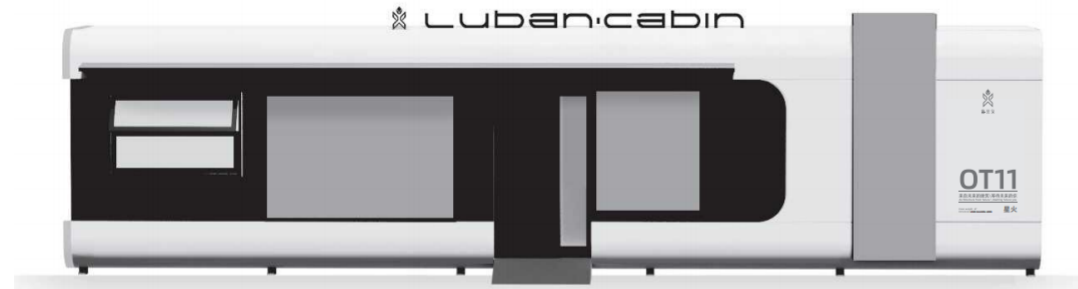

Export Version

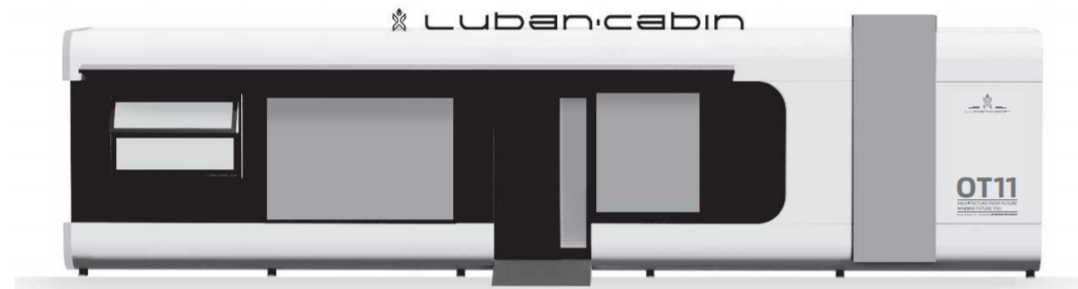

OT11

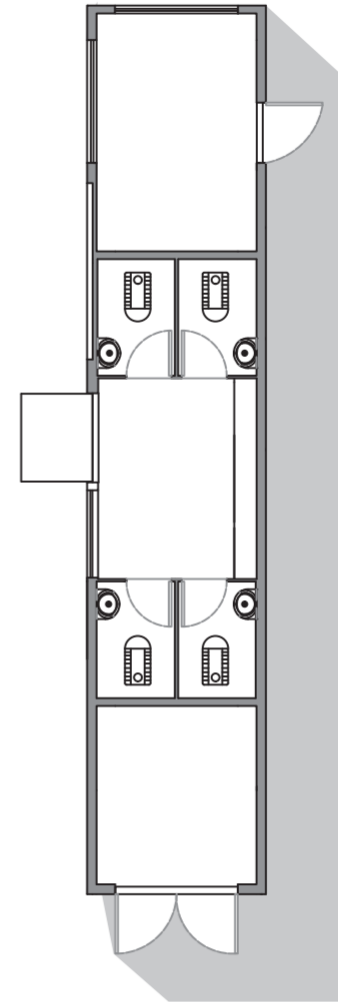

14 | PRODUCT SHOWCASE | OT11
LUBAN·CABIN

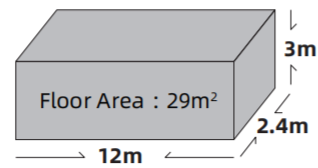

MAIN STRUCTURE:	Thickened steel frame, aluminum exterior panels, polyurethane insulation layer, aluminum doors and Windows, intelligent access control, foot support.
INTERNAL STRUCTURE:	Bamboo charcoal fiberboard wall, advanced waterproof composite wood floor, indoor and outdoor multi-color warm light, electric curtain, brand socket panel.
SANITARY WARE:	Squatting Toilet, Urinal, Cosmetic mirror, Automatic sensor faucet, Handrails for the disabled.
MAIN EQUIPMENT:	Monitoring Systems, Electrical Controls, Water Circuit, Lighting System, Large Display Screen, Exhaust system.
OPTIONAL:	Multimedia Screen, Vacuum System, Manure treatment system, Energy Storage Booster Pumps, Soap Wave Machine, Sweep code dispenser, Signage, Public Management Module.



15 | INTERNAL CONFIGURATION

LUBAN·CABIN





STARFIRE SERIES **OT10**



STARFIRE SERIES **OT30**



STARFIRE SERIES **OT40**



STARFIRE SERIES **OT50**



STARFIRE SERIES **OT80**



STARFIRE SERIES **OT90**

16 | USAGE SCENARIO

LUBARICABIN



BEAUTIFUL RURAL LUXURY RESORT ONE

It is convenient and eco-friendly to dismantle and build, it is the best choice for holding various themed activities, outdoor camping and accommodation activities, outdoor equipment exhibition.

CULTURAL AND TOURISM COMPLEX AND FOREST HEALTH VALLEY TWO

The capsule house adapt to a variety of terrain environment, and it is convenient for transportation. It provides a more superior choice for the development of cultural tourism and health care industry.

URBAN RENEWAL SPACE AND CITIZEN STATION THREE

It covers a small area and is practical, and can replace some public facilities in urban construction, such as blood donation point, public toilet, citizen station, etc.



04



05

SMART TOURISM SHARING CAMPING SITE

FOUR

It can be used for group building development, travel study research, travel camping to enhance the sense of experience and enjoy the ease of natural intimacy.

ECOLOGICAL RESORT HOTEL

FIVE

The resort hotel introduces the future cabin, which not only absorbs the eye and drains, but also saves time, land area and engineering cost.



06

EDUCATION, MEDICAL CARE, HEALTH CARE AND OLD-AGE CARE

SIX

In terms of education, medical care and health care for the elderly, it provides convenient stations and intelligent facilities to assist education and medical care, and the design is more humane.

17 CAMP PLANNING

LUBAN CABIN



Luban Cabin Starship X50

Luban Cabin Themed outdoor project

Luban Cabin Themed outdoor project

Luban Cabin Theme art landscape

Luban Cabin Starship T50

Luban Cabin Star walk

Luban Cabin Themed activity terrace

Luban Cabin Theme art landscape

Luban Cabin Starship X70

Luban Cabin Camp park intelligent access control

Luban Cabin Entrance terrace

ONE-STOP HIGH-END CAMP SOLUTION

LUBANICABIN | CHAPTER 4
ONE-STOP SERVICE



18 | LANDING CASE

LUBAN·CABIN



JILIN FOREST SLOW VALLEY TOURIST RESORT

Project location: Xiangyang Village, Badaohezi Town,
Jilin City

Design completion time: October 2016

Building area: 1130 square meters

Project scale: 30sets, The number of tourists has exceeded 1 million



HUBEI SUIZHOU MOONLIGHT SEA FISHING FIRE CAMPING

Design completion time: October 2017
 Building area: 3000 square meters
 Project scale: 85 sets



DAO TU HAI ZE IN YULIN,
 SHAAN XI PROVINCE

Design completion time: June 2017
 Building area: 1520m²
 Project scale: 80sets



SIHONG COUNTY LIUSHAN LAKE SCENIC SPOT

Design completion time: July 2018
 Building area: 2000m²
 Project scale: 98 sets



SICHUAN LIANGSHAN
 JINHUI FARM

Design completion time: May 2018
 Building area: 1600m²
 Project scale: 60 sets

19 | LANDING CASE

LUBAN·CABIN



TONGJIAJIANG TOURIST RESORT, TONGHUA, JILIN

Project location: Yanjiang Road, Dongchang District,
Tonghua City
Design completion time: December 2022
Building area: 5000 square meters
Project scale: 100sets, the number of visitors has exceeded 2
million



YUNXIAN SEVEN STAR ECOLOGICAL GROUP PROJECT DEPARTMENT,
LINCANG CITY, YUNNAN PROVINCE

Design completion time: June 2019
Construction area: 1860m²
Project scale: 56 sets



SHAANXI MIANXIAN LAOLISHI
CERAMICS

Design completion time: December
2019
Building area: 1000 square meters
Project scale: 50 sets



WAYAO VILLAGE, XIMALIN TOWN, ZHANGJIAKOU CITY,
HEBEI PROVINCE

Design completion time: December
2020
Building area: 2000m²
Project scale: 77 sets



SHANGLINZHAI SCENIC SPOT,
NANNING CITY, GUANGXI PROVINCE

Design completion time: June 2020
Building area: 1000 square meters
Project scale: 90sets

20 TRANSPORTATION MODE

LUBARICABIN





20 | TRANSPORTATION MODE

LUBARICABIN

REMARK

Before installing the product, the customer needs to complete the on-site engineering of water supply, power supply, sewage pipeline and load-bearing foundation according to our product standard basic hydropower drawings. Under the guidance of our technicians, it will be accurately positioned to the designed installation point. After the water and electricity are connected, the water and electricity test will be completed and handed over to the customer for acceptance.

1

Our company unified arrangement of truck transport to the project site.
The standard truck is 17.5m long semi-trailer, 3m transport width, transport height no more than 4.2m, can be free to pass the national highway.

2

After the goods arrive at the site, the customer needs to contact the local crane service. Our technical team will arrive at the site in advance for guidance. Lifting weight of 5 to 10 tons, it is recommended to use not less than 25 tons of crane loading and unloading.



Before installing the product, the customer needs to complete the on-site engineering of water supply, power supply, sewage pipeline and load-bearing foundation according to our product standard basic hydropower drawings. Under the guidance of our technicians, it will be accurately positioned to the designed installation point. After the water and electricity are connected, the water and electricity test will be completed and handed over to the customer for acceptance.

(一) STANDARD VERSION OF DISASSEMBLED TYPE

This version is a cleverly divided style of the standard size. Its design allows the cabin to be easily loaded into a 40-foot high container, greatly optimizing the use of transportation space, effectively reducing transportation costs, and ensuring the user experience after the customers receive the goods. However, please note that some simple manual assembly is required upon arrival, but this process is not complex and can be completed by following the instructions.



(二) REDUCED SIZE FULLY ASSEMBLED MODEL

To meet the loading requirements of a 40-foot high container, we have specially introduced this reduced size, fully assembled model. It has been moderately adjusted in height and width to ensure that the finished product can be shipped as a whole, without the need for additional disassembly. This not only saves on transportation costs but also eliminates the assembly process, further reducing labor costs.

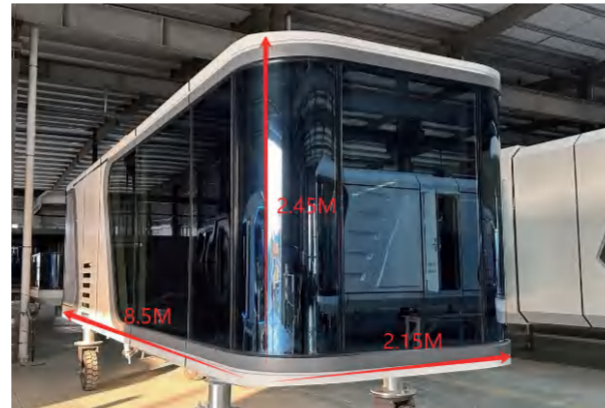

(三) STANDARD VERSION OF FLAT RACK CONTAINER MODEL

This version retains the standard dimensions, offering spacious and comfortable space that provides an excellent living experience for users. Due to its larger size, we have specially designed a flat rack container for shipping to ensure stability and safety during transport. Compared to other models, this version saves a considerable amount of labor costs. Upon arrival, only simple hoisting operations are needed, and it can be inhabited within two hours, making it convenient and fast.



21 | SIGNING CEREMONY

LUBARICABIN

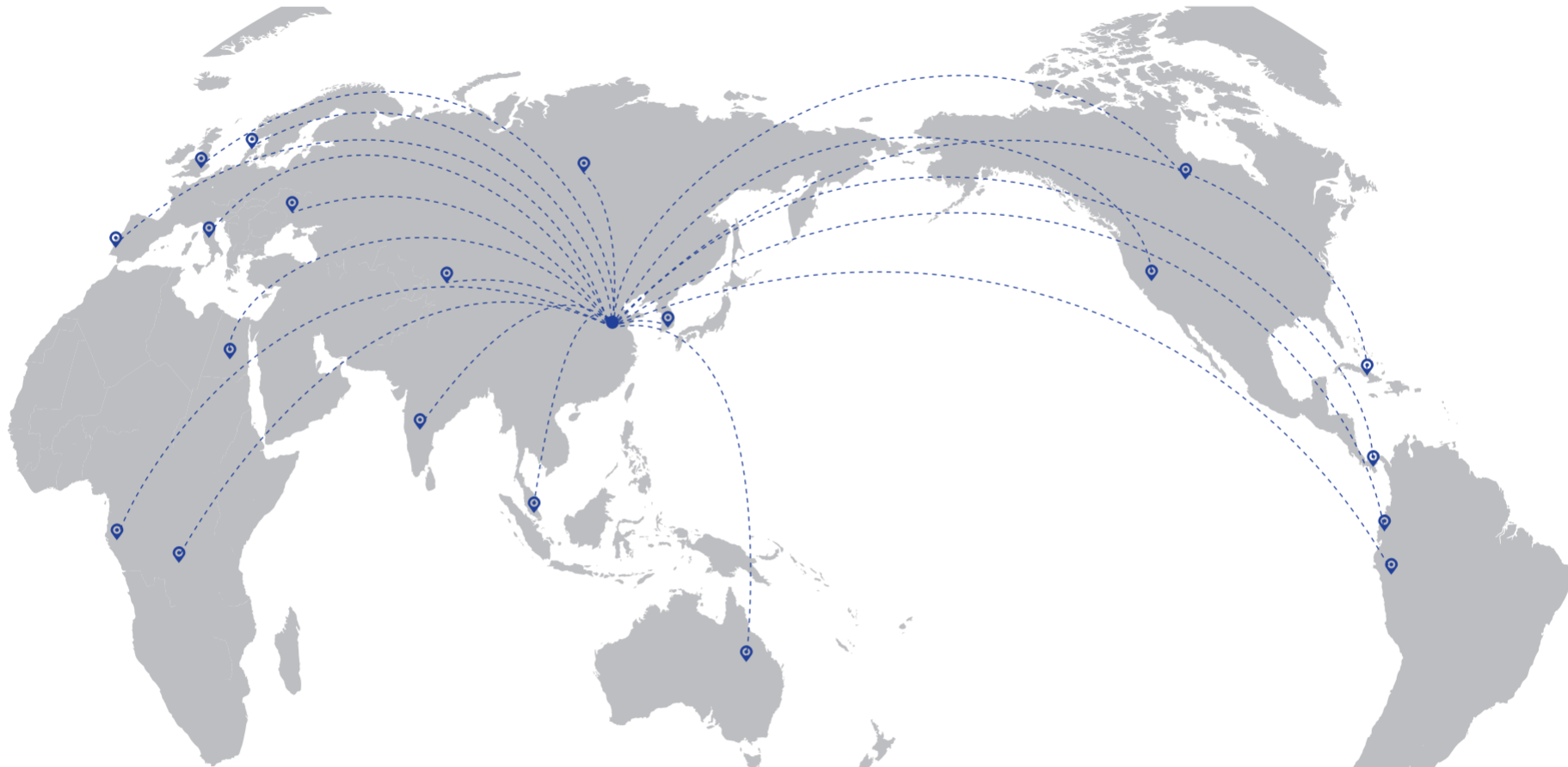
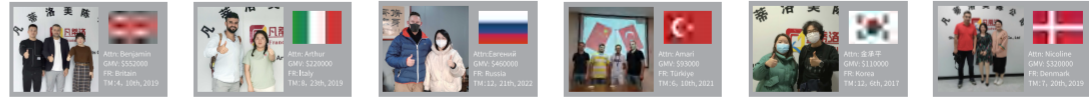

SERVED MORE THAN 60+ COUNTRIES

60⁺

SERVICE CUSTOMERS AS MANY AS 170+

370⁺



On October 5, 2018, XX company visited and expressed the willingness of the two sides to deepen mutually beneficial cooperation and promote common development in the future.

In mid-February 2020, Japanese representatives from CHEMIX Company paid a two-day visit to some factories of the future cabin, and hoped to achieve long-term in-depth cooperation through negotiations.

In May 2021, cooperation with Russian enterprises was reached, and Luban cabin will provide export services for Russian enterprises.

By 2025, Luban cabin will continue to deepen reform, accelerate structural adjustment, strengthen marketing, highlight the leadership of science and technology, and gradually expand the pace of development cooperation.

22 | BEAUTIFUL MOMENT

LUBAN·CABIN

2014

OUTING

Appreciate the spring scenery, embrace the beauty of nature, and dream back to the tranquility of the mountains.



2015

ALPINISM

Sweating profusely, enjoying the process of climbing the mountain, and even more enjoying the scenery on the top of the mountain.



2016

PRAIRIE TRAVEL

When the window is opened in the morning, the breeze of the prairie rushes in, which is as romantic as poetry and as beautiful as picturesque.



2017

GROUP FITNESS

Irrigate the flowers of career with painstaking efforts, cultivate eternal dreams with hope, life is endless, struggle is endless, work is good, business is prosperous!



THERE IS SUCH A GROUP OF PEOPLE

The best way to live is with a group of like-minded people,
Running together on the ideal road, there is a story all the way back,
There are firm footsteps, head up there is a clear distance.

Luban.cabin



2018- SANYA TRIP



2019- TRAVEL



2020- SURPRISE PARTY



2021-SUMMER NIGHT CAMPING



2022- GOD OF WEALTH



2023- FAMILY ACTIVITIES

23 | COOPERATION
BRAND
LUBARICABIN



COOPERATION PARTNER



COOPERATION PARTNER

A
R
C
H
I
T
E
C
T
U
R
E

F
R
O
M

F
U
T
U
R
E

•

W
A
I
T
I
N
G

F
U
T
U
R
E

Y
O
U

Shandong Endless Landscape Technology Co., Ltd.
Address: 109 Lingong Road, Yihexinqu, Linyi City, Shandong Province, China.
Service hotline: +0086 0539 8801801/701 0086 13864981313
Email: serena@lubancabin.com
www.lubancabin.com
www.meichenkeji.com